

## 1 Crystal Street, Belfast, BT5 5BS

**Price £139,950**

- Two Bed End-Terrace
- Spacious Living Area
- Two Excellent Size Bedrooms
- Modern Three-Piece Family Bathroom
- UPVC double glazed windows
- Ideally Placed Just Off Bloomfield Avenue, East Belfast
- Modern Fitted Kitchen
- Master bedroom comes with Built-in Storage & Slide robe
- Gas Fired Central Heating
- Backyard space to the Rear of the property

# 1 Crystal Street, Belfast BT5 5BS

Pleased to welcome this Superbly located 2-bedroom property to the market. 1 Crystal Street located just off Bloomfield Avenue, East Belfast. This excellent end terraced home is a must see to appreciate all it has to offer. This property is well placed to a multitude of local amenities that East Belfast has to offer. Connswater Retail Park is within walking distance from the house with leading Schools and excellent transports link also close by.

The property comprises of a bright and spacious living area with a log burner fire, leading through to the modern fitted kitchen & dining area.

Upstairs offers two excellent size bedrooms. Master with built in storage cupboard and slide robes. Modern three-piece family bathroom suite with an electric shower. Enclosed yard to the rear.

Furthermore, the property benefits from double glazed windows and Gas central heating throughout.

Early Viewing is Highly recommended, all viewings are strictly by appointment and can be arranged with Your Property Geeks Belfast on 028 90 598 583 or by clicking the enquire button.



Council Tax Band: Northern Ireland



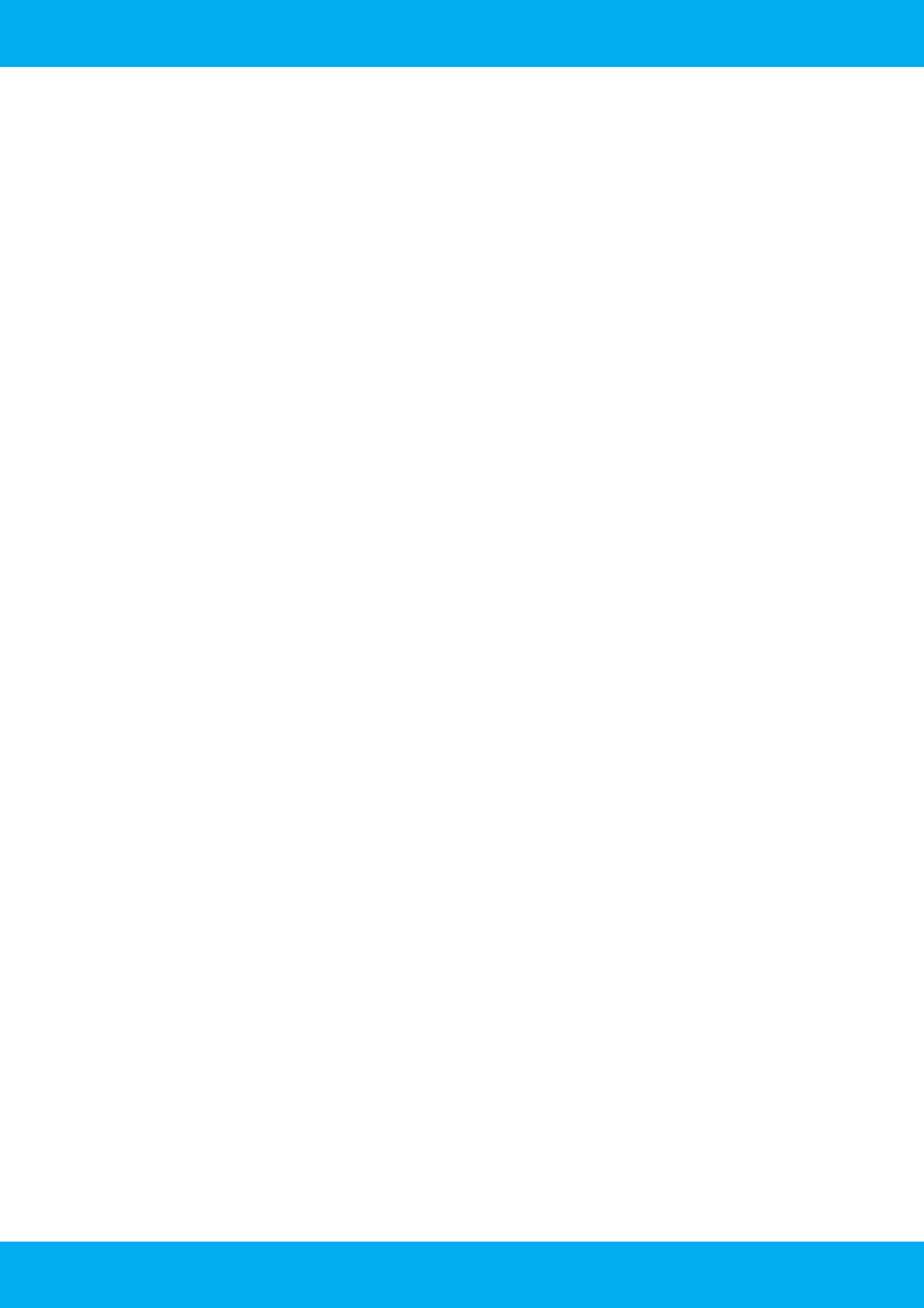

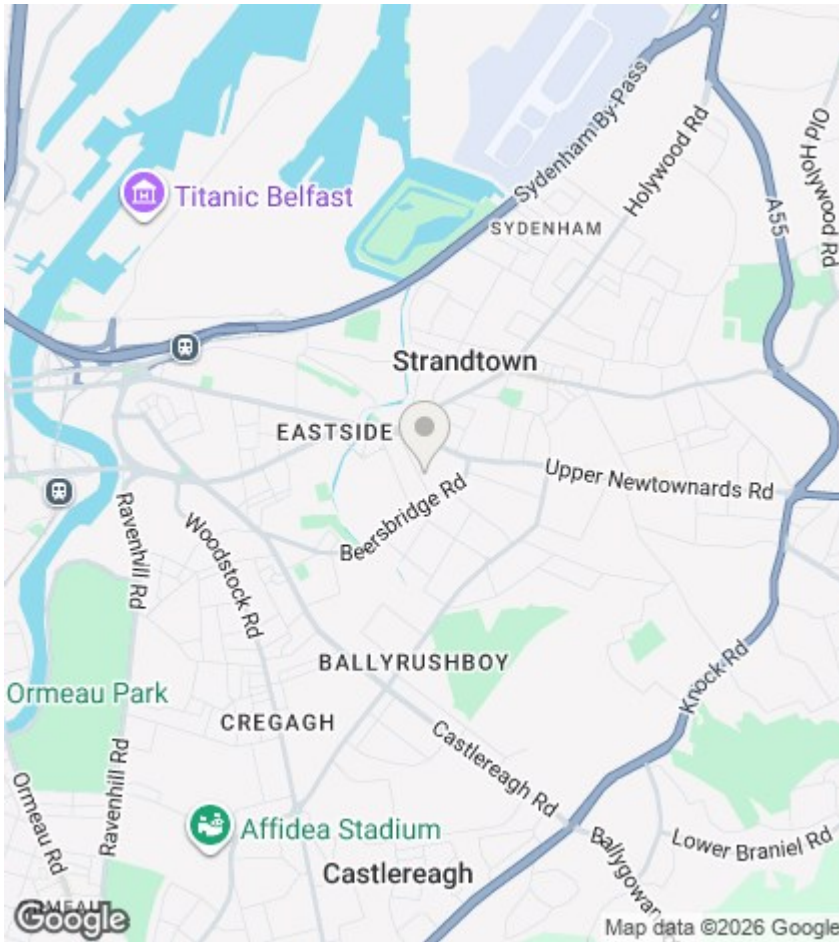

## Directions

## Viewings

Viewings by arrangement only. Call 02890598583 to make an appointment.

## EPC Rating:

C

Energy Efficiency Rating		Current	Potential
Very energy efficient - lower running costs			
(92 plus)	A		
(81-91)	B		
(69-80)	C	69	70
(55-68)	D		
(39-54)	E		
(21-38)	F		
(1-20)	G		
Not energy efficient - higher running costs			
Northern Ireland		EU Directive 2002/91/EC	

### Ground Floor

Approx. 28.4 sq. metres (305.3 sq. feet)

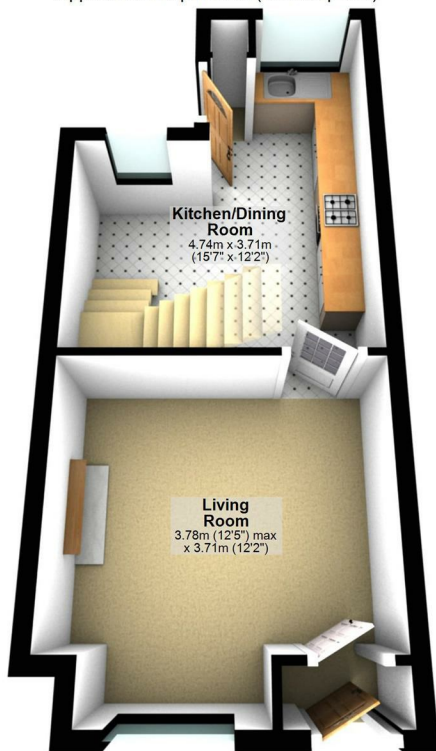

### First Floor

Approx. 27.5 sq. metres (295.6 sq. feet)



Total area: approx. 55.8 sq. metres (600.9 sq. feet)

Photos and Plans by houseflyni.co.uk  
Plan produced using PlanUp.

