



## 28 Loopland Park, Belfast, BT6 9DY

**£1,100 Per Month**

- 3-bedroom Furnished Property
- Ideally situated near Belfast City Centre
- Fully fitted Kitchen with white goods
- 4-Piece Family Bathroom with walk-in shower
- Double glazed windows
- Located just off the popular Cregagh Road in East Belfast
- Bright living room
- 3 Well proportioned bedrooms
- Gas central heating

# 28 Loopland Park, Belfast BT6 9DY

We are pleased to welcome 28 Loopland Park, a lovely 3-Bedroom home, to the market. This fantastic property is located just off the popular Cregagh Road in East Belfast and is situated close to local shops, schools, transport links, and Belfast City Centre. It provides both comfort and convenience for everyday living.

This Property boasts a bright and spacious living room. Fully fitted Kitchen with white goods included with adjoining dining area. 1st Floor comprises of 3 Well proportioned bedrooms and a modernised 4-Piece Family Bathroom with walk-in shower.

The property has the added benefit of double glazed windows fitted throughout and is serviced with gas central heating.

Please note you need to submit an email enquiry in order to get booked in for a viewing.



Council Tax Band: Northern Ireland



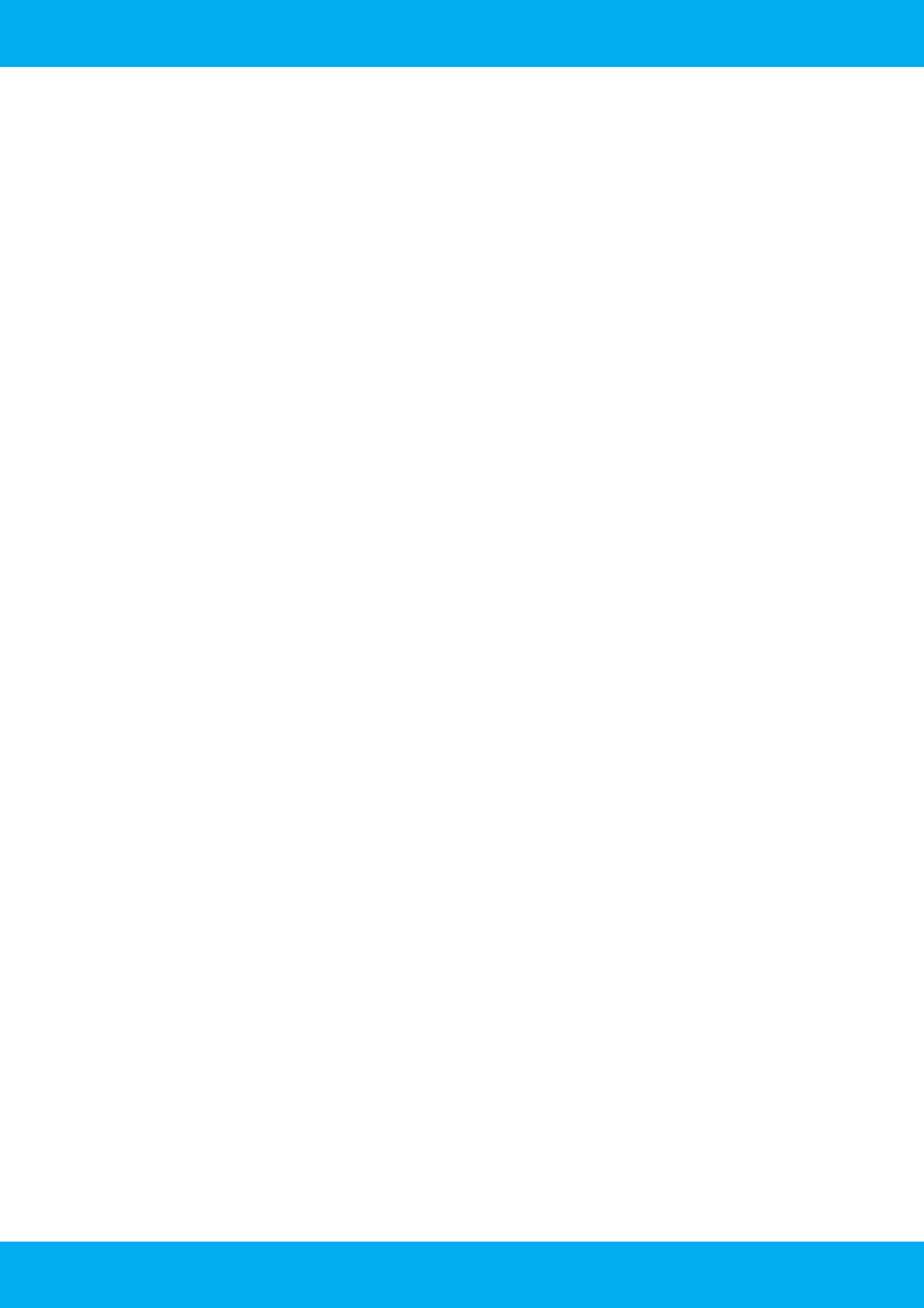

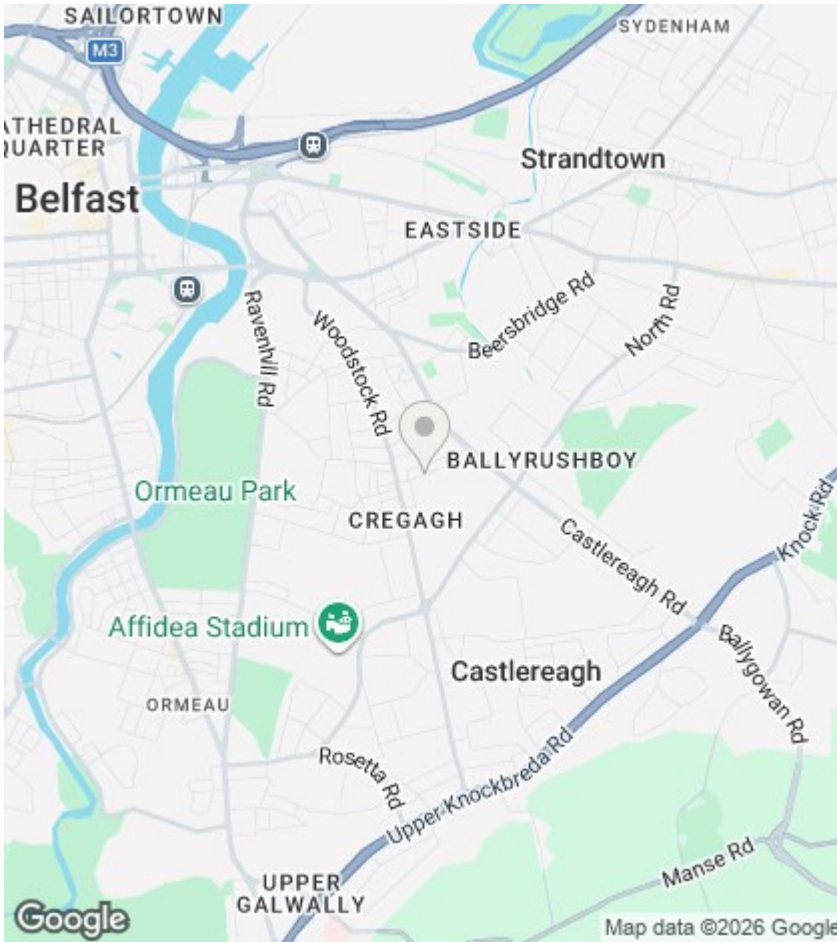

## Directions

## Viewings

Viewings by arrangement only. Call 02890598583 to make an appointment.

## EPC Rating:

E

Energy Efficiency Rating		Current	Potential
Very energy efficient - lower running costs			
(92 plus) <b>A</b>			
(81-91) <b>B</b>			
(69-80) <b>C</b>			
(55-68) <b>D</b>			
(39-54) <b>E</b>		41	
(21-38) <b>F</b>			
(1-20) <b>G</b>			
Not energy efficient - higher running costs			
<b>Northern Ireland</b>		EU Directive 2002/91/EC	

### Ground Floor

Approx. 43.7 sq. metres (470.4 sq. feet)

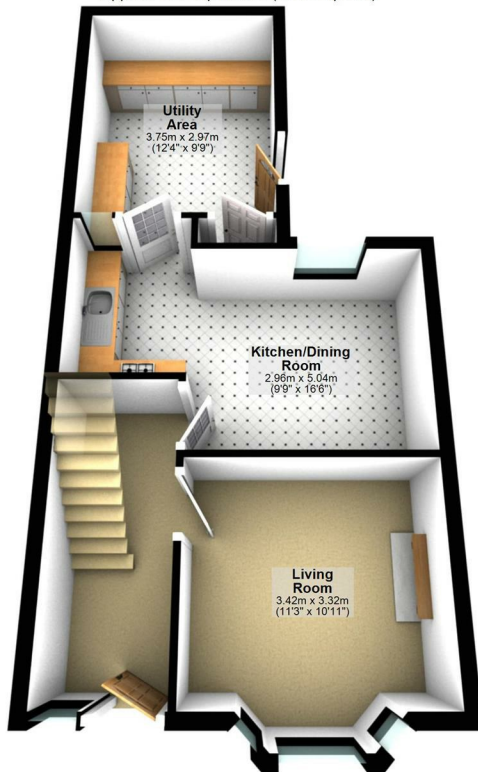

### First Floor

Approx. 31.1 sq. metres (334.8 sq. feet)

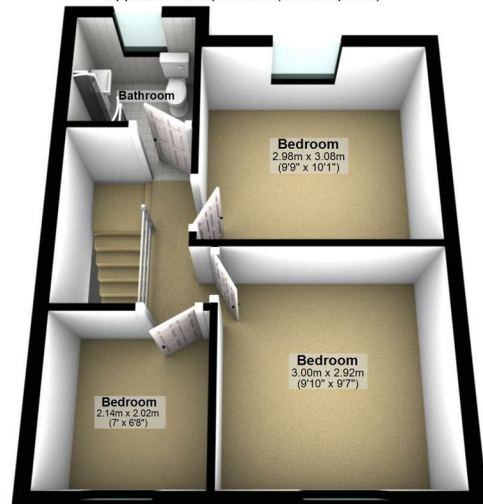

Total area: approx. 74.8 sq. metres (805.1 sq. feet)

Photos and Plans by houseflyni.co.uk  
Plan produced using PlanIt

