



## 47 Springfield Road Portavogie, Newtownards, BT22 1EP

"I think I'm actually speechless! I have literally run out of superlatives!" This is more than just a beautiful home - it's a lifestyle - one that embraces the sea, the beach and nature at its very best. The property began life as a stone cottage but has been significantly extended and fully modernised to create a truly beautiful home, that retains much of its original cottage feel, but with 3 generous first floor bedrooms and a potential 4th on the ground floor, it's anything but humble. Everything is finished to an exacting standard from the luxury kitchen/diner, with solid oak doors, to the lounge, with its mutil fuel stove and parquet flooring, and the two beautiful bathrooms, one on each floor making this a very practical home with potential to accommodate an elderly relative if required perhaps. So much of this home is about its setting though - those beautiful gardens with greenhouse, patio area, and lawns that lead you right to the dunes & the sea views and offers direct access, via wooden steps, to the beach. A lovely paved patio allows wonderful views of the beach as you relax at the end of the day and the range of brick and wooden sheds/workshops plus the detached cottage, which is currently utilised as a games room and utility area offers space to store, create or recharge. Properties like this don't come along ever day so contact us at your earliest opportunity to secure a personal viewing and see it for yourself.

**Offers Around £325,000**

# 47 Springfield Road

Portavogie, Newtownards, BT22 1EP



- Stunning detached home with direct access to the beach
- Modern kitchen/diner with patio doors to rear terrace
- Detached cottage with games room & utility area
- Please see our website for full details.
- Versatile accommodation - 3 first floor double bedrooms
- Luxury ground floor bathroom - First floor shower room
- Generous gardens in lawns with patio overlooking the beach
- Lounge with multi fuel stove
- Ground floor snug/bedroom 4
- uPVC double glazing - Oil fired central heating

## Entrance

### Entrance Porch

2'10x5'9 (0.86mx1.75m)

### Lounge

19x11'4 (5.79mx3.45m)

### Kitchen/Diner

13'6x11'4 (4.11mx3.45m)

### Rear Hallway

### Bathroom

7'3x5'10 (2.21mx1.78m)

### Snug/Bedroom 4

9'6x13'1 (2.90mx3.99m)

### First floor landing

## Shower Room

6'10x3'11 (2.08mx1.19m)

### Bedroom 1

15'1x12'2 (4.60mx3.71m)

### Bedroom 2

13'9x11'5 (4.19mx3.48m)

### Bedroom 3

13x11'4 (3.96mx3.45m)

### Cottage - Games room & Utility area

27'10x13 (8.48mx3.96m)

## Outside

## Tenure

## Property misdescriptions



## Directions



# Floor Plan

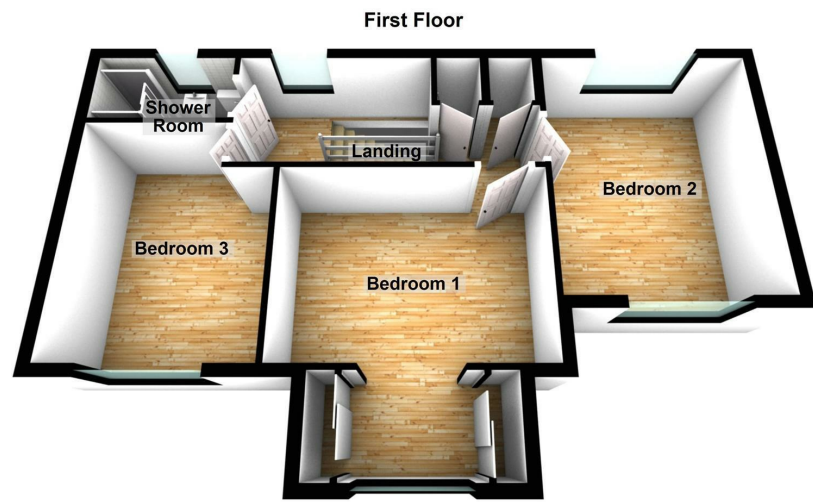
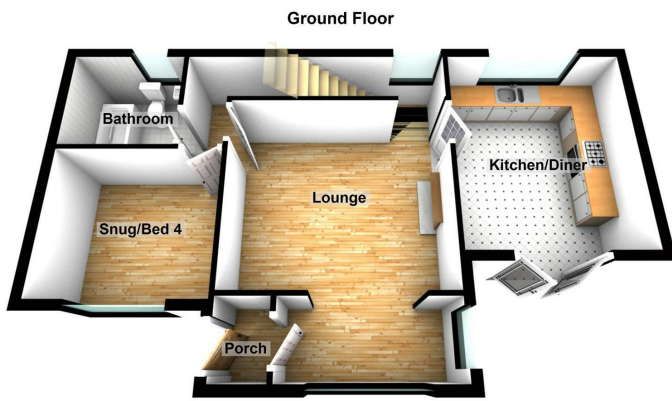

These particulars, whilst believed to be accurate are set out as a general outline only for guidance and do not constitute any part of an offer or contract. Intending purchasers should not rely on them as statements of representation of fact, but must satisfy themselves by inspection or otherwise as to their accuracy. No person in this firm's employment has the authority to make or give any representation or warranty in respect of the property.

