



19 Abbot Court , Newtownards, BT23 8US

"Every story has a beginning, even the biggest and best, so maybe this could be your the perfect begining to your home ownership story."

A straightforward terraced home offering 3 well proportioned bedrooms, a spacious lounge and kitchen/diner, a modern, fully tiled bathroom and a ground floor WC.

It benefits from uPVC double glazing and Phoenix gas central heating whilst, externally there is ample communal parking to the front and a paved garden to the rear with pleasant countryside views beyond.

A little TLC and refreshing wouldn't go amiss but it's a great starting point.

A first home, a fresh start or a buy to let investment, this property will suit a wide variety of buyers.

Offers Around £109,950

19 Abbot Court

, Newtownards, BT23 8US



- Terraced home
- Kitchen/diner
- Patio garden to rear
- Please see our website for full details
- 3 bedrooms
- Bathroom + Ground floor WC
- Communal paved parking area to front
- Lounge
- uPVC double glazing - Phoenix gas central heating
- Pleasant countryside aspect to rear

Entrance

Lounge

17'9x11'3 (5.41mx3.43m)

Kitchen/Diner

17'8x11'7 (5.38mx3.53m)

Hallway

WC

5'7x2 (1.70mx0.61m)

Landing

Bathroom

7'10x6'7 (2.39mx2.01m)

Bedroom 1

11'3x9'11 (3.43mx3.02m)

Bedroom 2

11'8x9'8 (3.56mx2.95m)

Bedroom 3

8'6x7'8 (2.59mx2.34m)

Outside

Tenure

Property misdescriptions

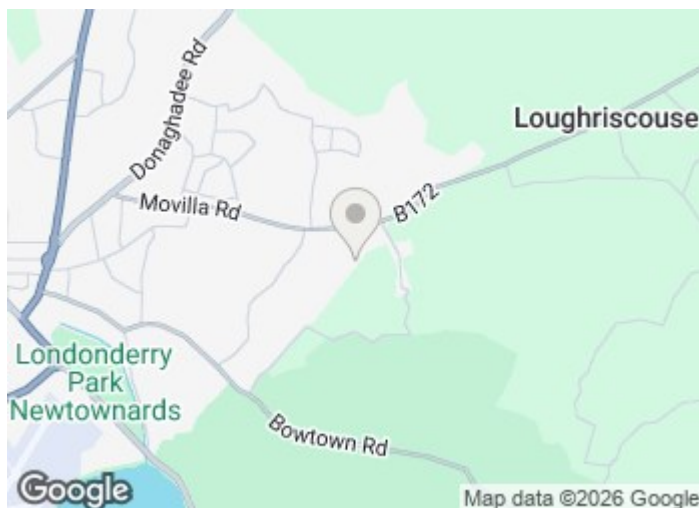

Directions



Floor Plan

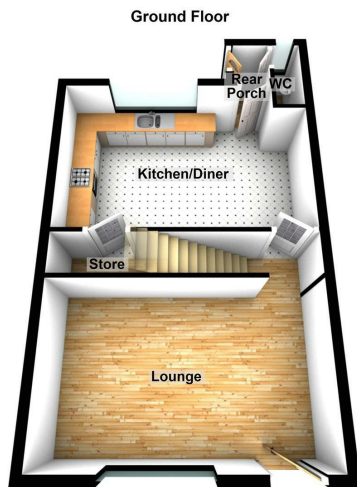

These particulars, whilst believed to be accurate are set out as a general outline only for guidance and do not constitute any part of an offer or contract. Intending purchasers should not rely on them as statements of representation of fact, but must satisfy themselves by inspection or otherwise as to their accuracy. No person in this firm's employment has the authority to make or give any representation or warranty in respect of the property.

