

2 Charles Place , Newtownards, BT23 7LU

Located close to the centre of Newtownards town, this mid terrace home has been in the same family ownership from new and would make an ideal and affordable first home or buy to let purchase. Decor wise it would benefit from some modernising to your own tastes but it already benefits from uPVC double glazing & fascia and a new oil fired boiler a few years ago.

The first floor benefits from the additional space above the under pass and offers 3 surprisingly spacious and well proportioned bedrooms, all with built in storage, plus a family bathroom. The ground floor follows a traditional layout of a lounge/diner, with feature tiled fireplace, and a galley style kitchen. Externally everything has been kept low maintenance with paved gardens front and rear, a brick garden shed and a brick boiler house. Early viewing advised.

Offers Around £117,500

2 Charles Place , Newtownards, BT23 7LU



- Mid terraced home in town centre location
- Kitchen
- Oil fired central heating
- Please see our website for full details
- 3 bedrooms
- Bathroom
- Low maintenance gardens to front & rear
- Lounge with feature fireplace
- uPVC double glazing & fascia
- Ideal first home or buy to let

Entrance

Entrance hall

11'9x6 (3.58mx1.83m)

Lounge/diner

21'2x11'8 (6.45mx3.56m)

Kitchen

8'4x8'2 (2.54mx2.49m)

Landing

Bathroom

6'3x5'7 (1.91mx1.70m)

Bedroom 1

13'6x12'4 (4.11mx3.76m)

Bedroom 2

13'7x8'8 (4.14mx2.64m)

Bedroom 3

9'5x9'7 (2.87mx2.92m)

Outside

Tenure

Property misdescriptions

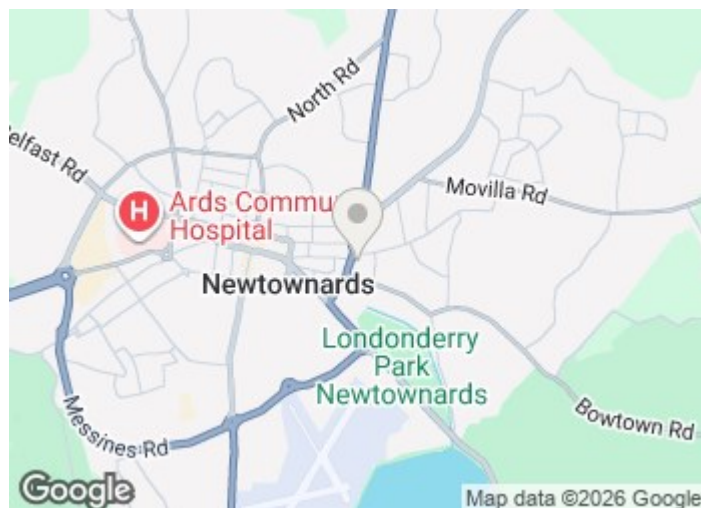

Directions



Floor Plan

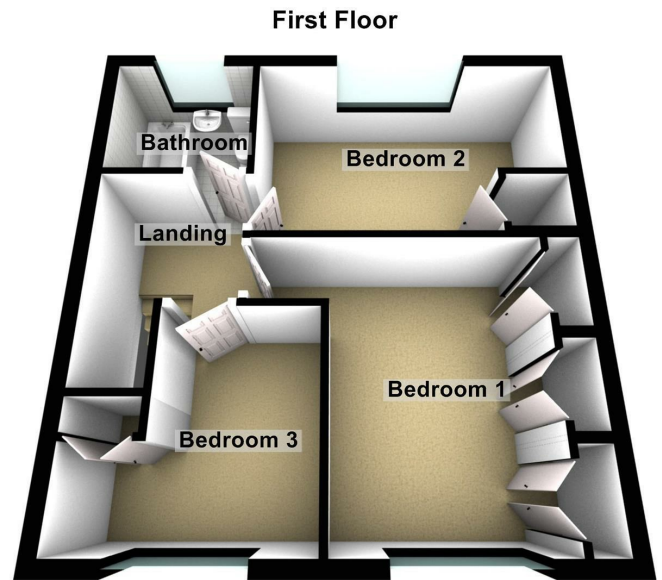
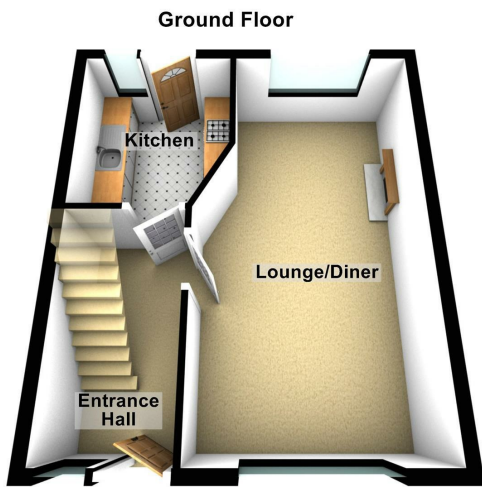

These particulars, whilst believed to be accurate are set out as a general outline only for guidance and do not constitute any part of an offer or contract. Intending purchasers should not rely on them as statements of representation of fact, but must satisfy themselves by inspection or otherwise as to their accuracy. No person in this firm's employment has the authority to make or give any representation or warranty in respect of the property.

