



## 3 Harbour Road , Ballyhalbert, BT22 1BW

A permanent home, a holiday home or an Air B&B - this enviable cottage has been modernised to an exacting standard yet retains much of its original charm and, with the beach and sea just directly across the road, where else would you rather be?

The recent owners have done an amazing job refreshing this beautiful home and have added some real luxury touches. Windows have been upgraded as have the roof, the central heating system, the kitchen, the bathroom, the flooring - it's almost a new house set within this charming cottage!

As you enter the property you'll notice the staircase to the first floor with its oak, spindle handrail and the quality wood flooring to the lounge. You'll also notice the oak internal doors and the high standard of presentation throughout. The ground floor provides a lounge, a kitchen, a bathroom and two bedrooms whilst the first floor is set aside for an additional bedroom or sitting room, taking full benefit of those beautiful sea views with a large picture window. But there's more... Step out of the kitchen and you'll find a beautiful garden in lawn with fruit trees, a brick paved patio and a summer house.

This is a unique opportunity and internal viewing is essential to fully appreciate this charming home.

**Offers Over £169,950**

# 3 Harbour Road

, Ballyhalbert, BT22 1BW



- Coastal property with excellent sea views & beach access
- Beautifully modernised throughout
- 3 bedrooms - 2 on ground floor
- Lounge with feature wood burning stove
- Modern bathroom
- Modern fitted kitchen
- Newly fitted uPVC double glazing - Recently upgraded oil fired central heating
- Generous garden to rear in lawn with paved patio & summer house
- Private access to rear for bin and oil deliveries etc
- Please see our website for full details

## Entrance

## Lounge

14'11x14 (4.55mx4.27m)

## Kitchen

11'8x7'2 (3.56mx2.18m)

## Bathroom

8'5x6'5 (2.57mx1.96m)

## Bedroom 2

14'6x9'8 (4.42mx2.95m)

## Bedroom 3

12'3x6'9 (3.73mx2.06m)

## Upstairs

## Bedroom 1/Sitting room

13'10x13'5 (4.22mx4.09m)

## Outside

## Tenure

## Property misdescriptions

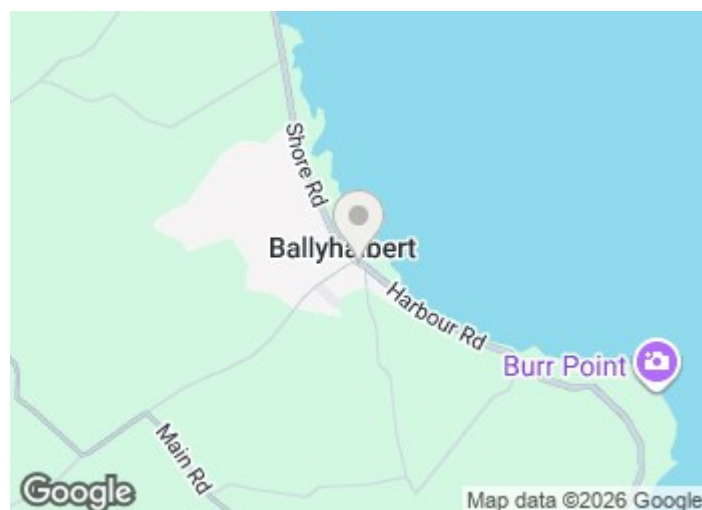

## Directions

Located on the coast road just past the mini roundabout in Ballyhalbert, facing the shore.



# Floor Plan

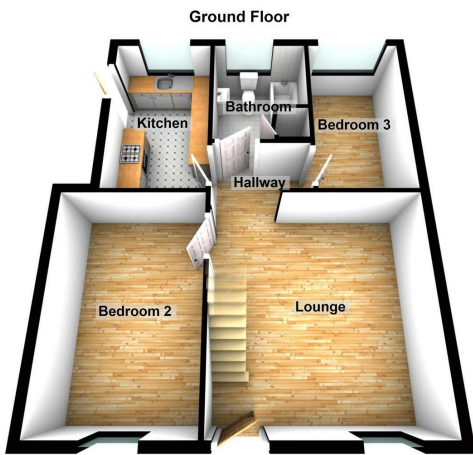

Images for illustrative purposes only and subject to change.  
Plan produced using PlanUp.

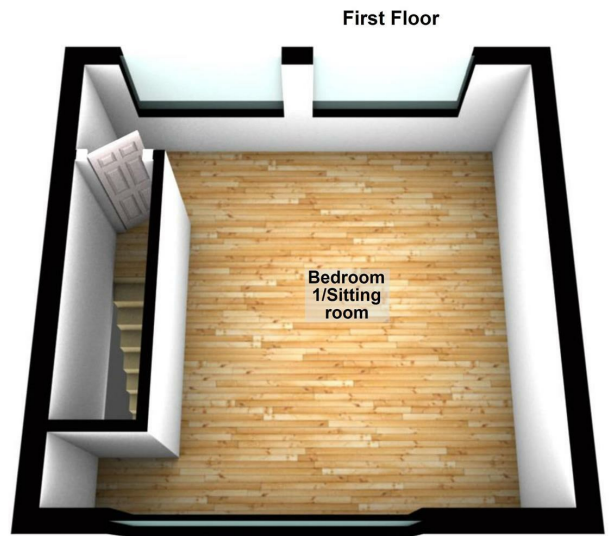

These particulars, whilst believed to be accurate are set out as a general outline only for guidance and do not constitute any part of an offer or contract. Intending purchasers should not rely on them as statements of representation of fact, but must satisfy themselves by inspection or otherwise as to their accuracy. No person in this firm's employment has the authority to make or give any representation or warranty in respect of the property.

