



## 24 Castle Meadows

Carrowdore, Newtownards, BT22 2TZ

Located in a pleasant and relatively modern private development this semi detached home would make an excellent first time purchase or first family home.

It offers 3 bedrooms, a family bathroom, a lounge with feature fireplace, a kitchen with dining area and a very useful conservatory to the rear. It benefits from uPVC double glazing & fascia plus oil fired central heating and is nicely presented throughout.

Externally there are gardens to front, side and rear with a tarmac driveway and paved patio areas.

Strangford College is nearby as is the Eurospar and Primary school whilst Newtownards, Bangor and the beautiful Ards Peninsula are all within easy access by road.

Internal viewing is strongly recommended.

**Offers Around £167,500**

# 24 Castle Meadows

Carrowdore, Newtownards, BT22 2TZ



- Semi detached home
- Kitchen with dining area
- uPVC double glazing & fascia - Oil fired central heating
- Please see our website for full details
- 3 bedrooms
- Conservatory to rear
- Gardens to front, side & rear in lawn with paved patio area
- Lounge with feature fireplace
- Family bathroom
- Tarmac driveway

## Entrance

### Entrance hall

### Lounge

19'3x11'4 (5.87mx3.45m)

### Kitchen/diner

19'3x9 (5.87mx2.74m)

### Conservatory

17'3x9'8 (5.26mx2.95m)

### Landing

### Bathroom

7'10x6 (2.39mx1.83m)

### Bedroom 1

13'2x10'3 (4.01mx3.12m)

### Bedroom 2

11'2x9 (3.40mx2.74m)

### Bedroom 3

9'6x8'10 (2.90mx2.69m)

### Outside

### Tenure

### Property misdescriptions



### Directions



# Floor Plan

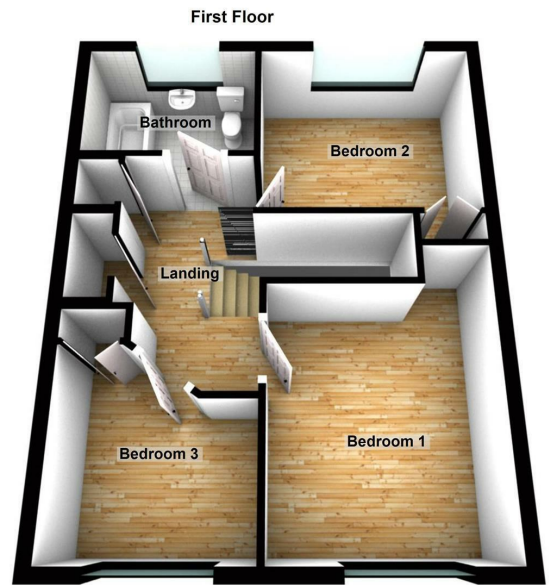
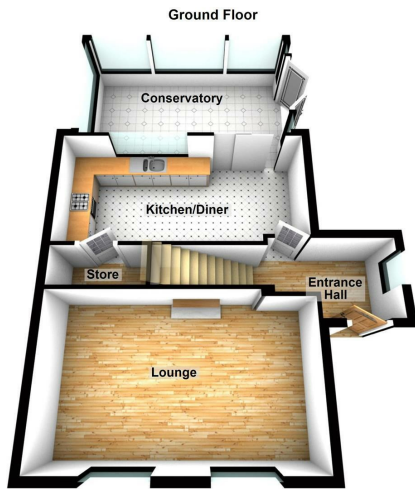

These particulars, whilst believed to be accurate are set out as a general outline only for guidance and do not constitute any part of an offer or contract. Intending purchasers should not rely on them as statements of representation of fact, but must satisfy themselves by inspection or otherwise as to their accuracy. No person in this firm's employment has the authority to make or give any representation or warranty in respect of the property.

