



## 18 Park Hill

, Dromore, BT25 1PL

**£825 Per month**

Cairns and Downing Sales and Lettings are delighted to bring to the rental market this very attractive end terrace property situated within a residential location on the edge of Dromore Town, convenient to the local amenities as well as primary & nursery schools and excellent road networks to other towns and cities.

Internally the property is comprised of entrance hall through to a spacious living room with open fire, a fitted kitchen with a range of high and low level units and also separate shower room. Moving on to the bedrooms, you will find three well-appointed rooms (two with built in robes).

Outside you will find a spacious rear garden laid in paving. The front garden is also laid in paving with driveway to side.

Contact Cairns & Downing Sales & Lettings on 028 96223011 to arrange your appointment for this lovely property that is new to the rental market in Dromore.

### Viewing

Please contact our Cairns and Downing Office on 02896 223 011 if you wish to arrange a viewing appointment for this property or require further information.

- Well Presented End Terrace Property Situated Within A Popular Location Close To Dromore Town
- Spacious Lounge With Open Fire
- Spacious Kitchen And Dining Area
- Separate Luxury Shower Room
- Three Well Appointed Bedrooms (Two With Built In Robes)
- Available Now!
- Front And Rear Garden Laid In Paving
- Driveway To Side
- Double Glazed Windows
- Oil Fired Central Heating System





Floor Plan

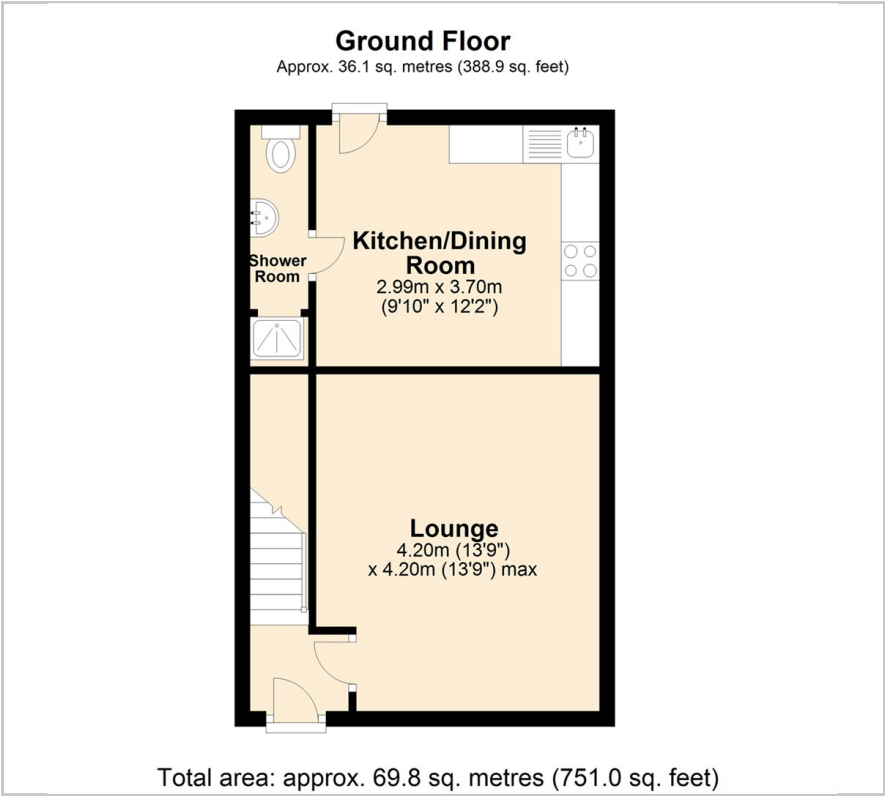

Area Map



Energy Efficiency Graph

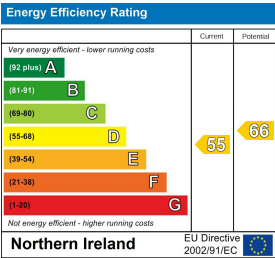

These particulars, whilst believed to be accurate are set out as a general outline only for guidance and do not constitute any part of an offer or contract. Intending purchasers should not rely on them as statements of representation of fact, but must satisfy themselves by inspection or otherwise as to their accuracy. No person in this firms employment has the authority to make or give any representation or warranty in respect of the property.