

32 Meadow Park , Newtownards, BT23 8XX

Located just off Abbot Drive this end of terrace bungalow has been really nicely presented by its present owner and would suit first time buyers, retirees, those with restricted mobility or Buy to let investors alike.

It offers 2 bedrooms, both with large built in storage cupboards, a lounge, a lovely modern bathroom and an equally fresh kitchen with casual dining area plus a rear hallway/storage area.

It benefits from uPVC double glazing & Phoenix gas central heating whilst, externally, there are gardens in lawn to front & rear plus a parking area.

The property has been realistically priced for the current market and internal viewing is highly recommended.

Offers Around £125,000

32 Meadow Park

, Newtownards, BT23 8XX



- Nicely presented end terrace bungalow
- 2 bedrooms - both with built in storage
- Lounge
- Modern kitchen with casual dining area
- Modern bathroom
- uPVC double glazing & fascia
- Phoenix gas central heating
- Gardens to front & rear with off street parking
- Nicely modernised - Ideal first home or retirement home
- Please check our website for full details

Entrance

Entrance hall

Lounge

13'1x10'10 (3.99mx3.30m)

Kitchen/diner

10'2x9'11 (3.10mx3.02m)

Rear hallway

10'3x3'1 (3.12mx0.94m)

Bathroom

7x6'8 (2.13mx2.03m)

Bedroom 1

10'4x10'3 (3.15mx3.12m)

Bedroom 2

10'1x8'7 (3.07mx2.62m)

Outside

Tenure

Property misdescriptions

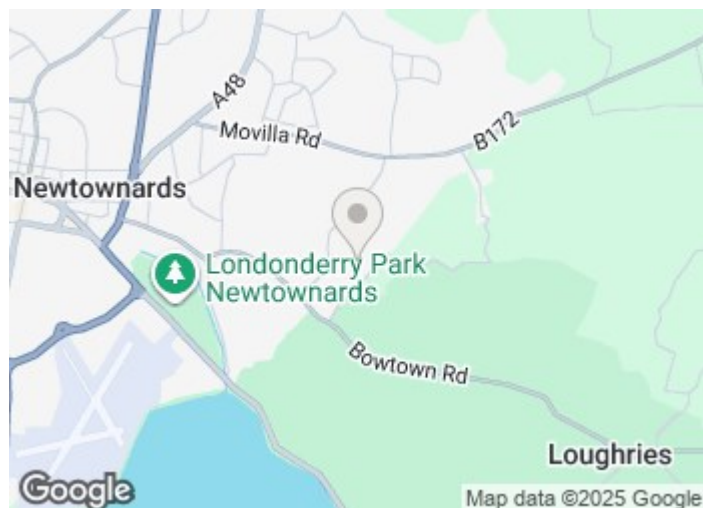

Directions



Floor Plan

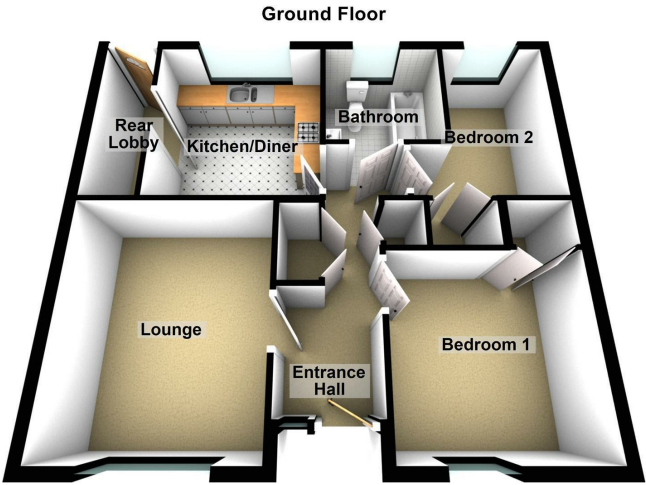



NIMortgages.com
Your Local Mortgage Experts

First home or 21st home, call us for expert advice on all your mortgage options.

02891 828100



These particulars, whilst believed to be accurate are set out as a general outline only for guidance and do not constitute any part of an offer or contract. Intending purchasers should not rely on them as statements of representation of fact, but must satisfy themselves by inspection or otherwise as to their accuracy. No person in this firms employment has the authority to make or give any representation or warranty in respect of the property.

