



## 10 Bailie Park

The Cotton, Donaghadee, BT19 7QN

Set in the ever popular "Cotton" area between Donaghadee, Bangor and Newtownards, this mid terrace home has been beautifully presented by its present owner and boasts uninterrupted countryside views to the rear.

The property offers 3 first floor bedrooms, a family bathroom, a well proportioned lounge, with real wood flooring and attractive mock fireplace and hearth, and a practical kitchen with dining area to the rear.

The property benefits from uPVC double glazing & fascia and oil fired central heating whilst, externally, there is a lawned garden to the front and an enclosed low maintenance yard to the rear with timber decking overlooking agricultural fields - perfect for relaxing summer evenings.

Ideally located for ease of access to all surrounding towns this property would make an ideal first home, fresh start or buy to let investment and should be viewed internally to be fully appreciated.

**Offers Around £145,000**

# 10 Bailie Park

The Cotton, Donaghadee, BT19 7QN



- Beautifully presented terraced home
- Kitchen/diner
- Oil fired central heating
- Semi rural Cul de sac location
- 3 bedrooms
- Bathroom
- Garden to front in lawn - Enclosed yard to rear with decking
- Lounge with real wood flooring
- uPVC double glazing & Fascia
- Countryside views to rear

## Entrance

## Entrance hall

## Lounge

14'5x13'6 (4.39mx4.11m)

## Kitchen/diner

17x9'6 (5.18mx2.90m)

## Landing

## Bathroom

6'2x5'9 (1.88mx1.75m)

## Bedroom 1

14'7x10'5 (4.45mx3.18m)

## Bedroom 2

10'5x8'9 (3.18mx2.67m)

## Bedroom 3

10x8 (3.05mx2.44m)

## Outside

## Tenure

## Directions

## Property misdescriptions



## Directions

Travelling from Six Road Ends Roundabout towards Donaghadee turn left into Bailie Road then right into Bailie Park to where number 10 is located on the left.





Floor Plan

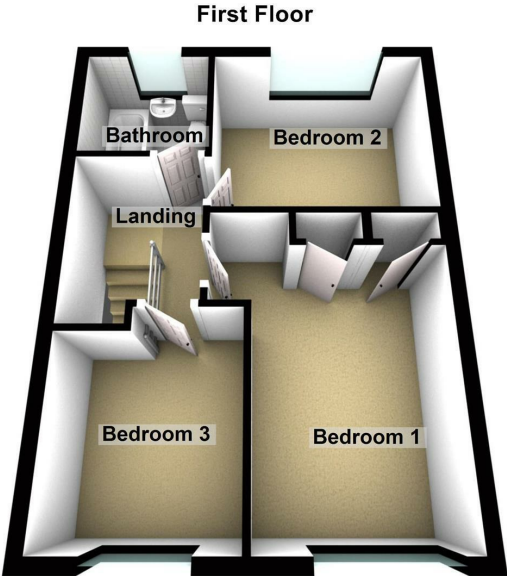
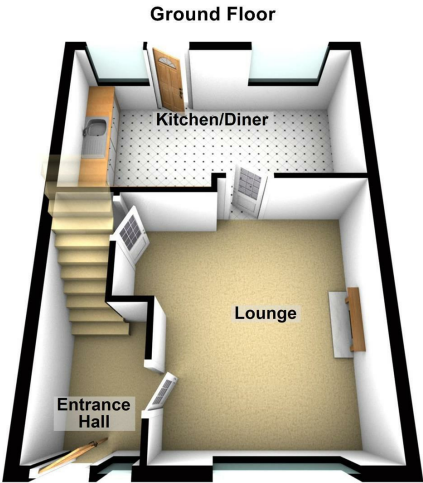

These particulars, whilst believed to be accurate are set out as a general outline only for guidance and do not constitute any part of an offer or contract. Intending purchasers should not rely on them as statements of representation of fact, but must satisfy themselves by inspection or otherwise as to their accuracy. No person in this firms employment has the authority to make or give any representation or warranty in respect of the property.

