

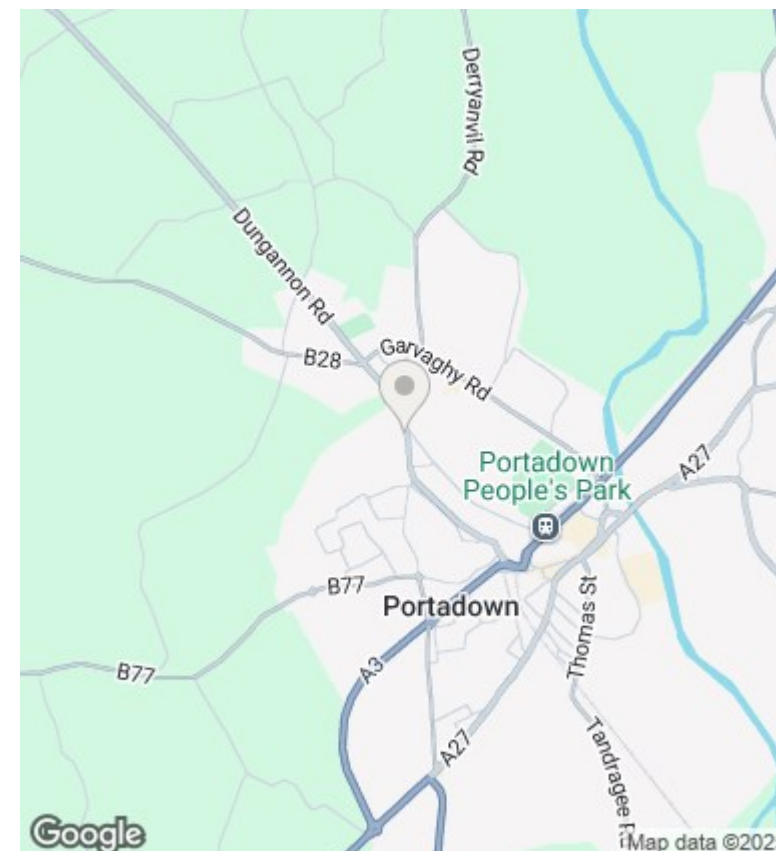

7 Corcrair Gardens, Portadown, Craigavon, County Armagh, Offers Over £94,950

- Spacious Three Bedroom Family Home
- Kitchen/Dining Area with an Array of High & Low Fitted Units & Integrated Appliances
- Large Fully Enclosed Rear Garden
- Suitable for Co-ownership
- Three Well Proportioned Bedrooms
- Gas Fired Central Heating
- Large Lounge Featuring an Open Fire place
- Three Piece Family Bathroom Suite
- Situated Near Craigavon Area Hospital, Rushmere Shopping Centre, Craigavon Omniplex, South Lake Leisure Centre, Portadown Town Centre, Schools, Restaurants, Nightlife and Other Local Amenities as well as M1 Interchange.

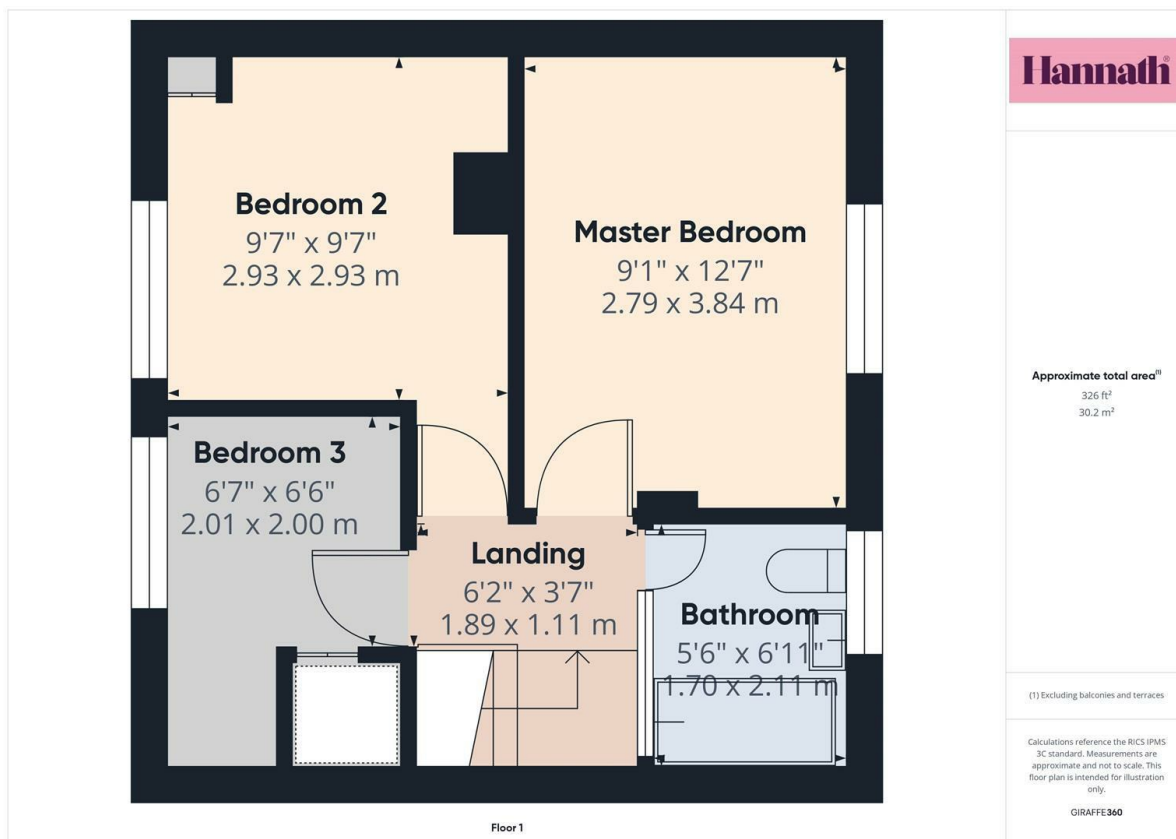

Directions

Located off Corcra Road, Portadown. Situated Near Craigavon Area Hospital, Rushmere Shopping Centre, Craigavon Omniplex, South Lake Leisure Centre, Portadown Town Centre, Schools, Restaurants, Nightlife and Other Local Amenities as well as M1 Interchange.

Viewings

Viewings by arrangement only. Call 02838 399911 to make an appointment.

Council Tax Band

Northern Ireland

EPC Rating:

| Energy Efficiency Rating | | |
|---|-------------------------|-----------|
| | Current | Potential |
| Very energy efficient - lower running costs | | |
| (92 plus) A | | |
| (81-91) B | | |
| (69-80) C | | |
| (55-68) D | | |
| (39-54) E | | |
| (21-38) F | | |
| (1-20) G | | |
| Not energy efficient - higher running costs | | |
| Northern Ireland | EU Directive 2002/91/EC | |