

1A Beverley Crescent , Newtownards, BT23 7UN

If you're looking for a first home or a fresh start then this could be the ideal property for you.

Located just off the Bangor Road in Newtownards and therefore within easy reach of Newtownards, Bangor & beyond, this semi detached home has just benefitted from a programme of refreshing and should be viewed to be appreciated.

The property offers 3 bedrooms, a bathroom (shower room), an open plan lounge/dining room, with multi fuel stove & patio doors to the rear garden, and a kitchen. It benefits from uPVC double glazing & fascia and oil fired central heating. Externally there is a generous single garage with tarmac driveway and low maintenance gardens to front and rear with paved patio.

All in all it's a great, straightforward home in a popular residential location that would serve a future owner very well. Viewings strictly by prior appointment.

Offers Around £185,000

1A Beverley Crescent

, Newtownards, BT23 7UN



- Semi detached home in ideal location
- Recently refreshed and updated
- 3 bedrooms
- Kitchen
- Lounge/dining room with multi fuel stove
- Bathroom
- uPVC double glazing & fascia - Oil fired central heating
- Generous detached garage
- Low maintenance gardens to front and rear terraced beds
- Ideal first time buy

Entrance

Entrance hall

12'4x6'6 (3.76mx1.98m)

Lounge

12'4x11'4 (3.76mx3.45m)

Dining room

11'11x9 (3.63mx2.74m)

Kitchen

11'10x8'9 (3.61mx2.67m)

Landing

Bathroom

6'5x6 (1.96mx1.83m)

Bedroom 1

11'11x11'4 (3.63mx3.45m)

Bedroom 2

12'4x10'7 (3.76mx3.23m)

Bedroom 3

9'1x9 (2.77mx2.74m)

Detached garage

20'1x12 (6.12mx3.66m)

Outside

Tenure

Property misdescriptions

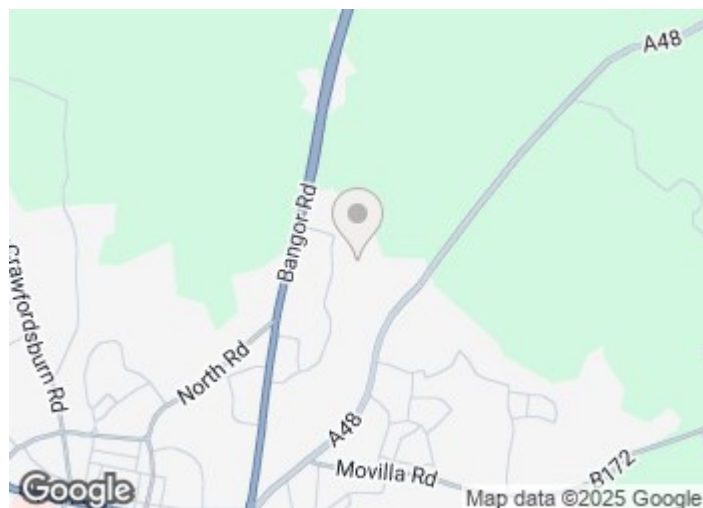

Directions

Travelling out of Newtownards along Bangor Road turn right into Beverley Heights at the start of the dual carriageway. Follow the road around then turn left into Beverley Crescent and number 1A is located on the corner on the right just around the first bend.



Floor Plan

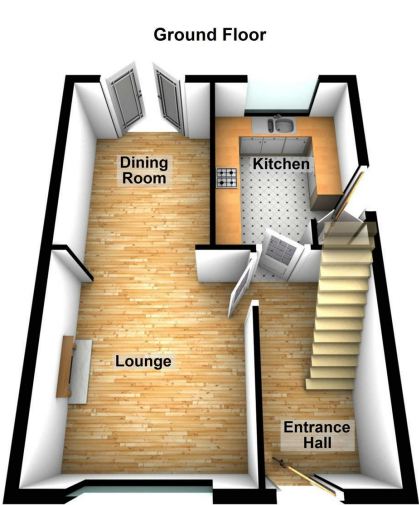

These particulars, whilst believed to be accurate are set out as a general outline only for guidance and do not constitute any part of an offer or contract. Intending purchasers should not rely on them as statements of representation of fact, but must satisfy themselves by inspection or otherwise as to their accuracy. No person in this firms employment has the authority to make or give any representation or warranty in respect of the property.

