



## 6 Knightsbridge Mews, Belfast, BT9 5EW

**Price Guide £200,000**

Located just off Knightsbridge Park in a quiet cul-de-sac, we are pleased to offer for sale this well presented semi-detached chalet bungalow. Well suited to a range of potential purchasers including first time buyers, investors or those downsizing, this home is close to a host of local amenities in the surrounding area including shops, public transport links, the Lagan Tow Path and the leisure facilities at The Belfast Boat Club. The accommodation is well proportioned and comprises two good sized bedrooms, spacious living / dining room, kitchen, conservatory & bathroom suite. Properties within this development rarely come to market therefore viewing is recommended.

- Well Presented Semi - Detached Chalet Bungalow
- Large Living / Dining Area & Conservatory
- Recently Re-wired
- Allocated Parking Space & Visitor Parking
- Two Good Sized Bedrooms Both With Built In Robes
- Enclosed Rear Garden In Lawn
- Oil Fired Central Heating / Double Glazed
- Walking Distance To Lagan Tow Path & Stranmillis Village

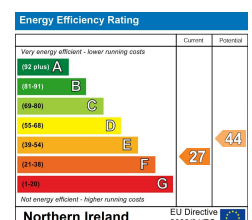



**THE ACCOMMODATION COMPRISES  
ON THE GROUND FLOOR**

**ENTRANCE**

Hardwood front door with glass panels.

**LIVING / DINING 17'0" x 16'0" (5.2 x 4.9)**



Laminate wood floor. Attractive gas fire.

**KITCHEN 7'10" x 7'2" (2.4 x 2.2)**



High and low level units, single drainer stainless steel sink unit with mixer tap, plumbed for washing machine & dishwasher, part tiled walls, tiled floor.

**CONSERVATORY 11'5" x 10'2" (3.5 x 3.1)**



Laminate wood floor.

**ON THE FIRST FLOOR**

Storage off landing.

**BEDROOM ONE 12'9" x 10'5" (3.9 x 3.2)**



Sliding mirrored robe.

**BEDROOM TWO 11'5" x 9'2" (3.5 x 2.8)**



Sliding mirrored robe.

## BATHROOM



White suite comprising panel bath with shower over, pedestal wash hand basin, low flush W.C.

## OUTSIDE



Enclosed rear garden in lawn.

Floor Plan

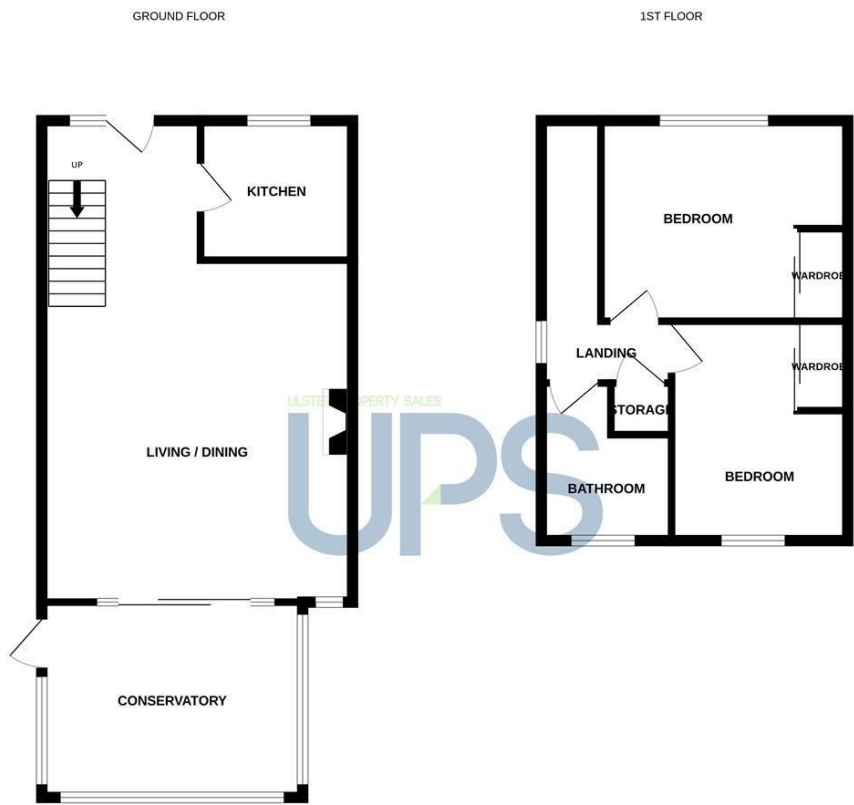

Whilst every attempt has been made to ensure the accuracy of the floorplan contained here, measurements of doors, windows, rooms and any other items are approximate and no responsibility is taken for any error, omission or mis-statement. This plan is for illustrative purposes only and should be used as such by any prospective purchaser. The services, systems and appliances shown have not been tested and no guarantee as to their operability or efficiency can be given.  
Made with Metropix C2025

Area Map

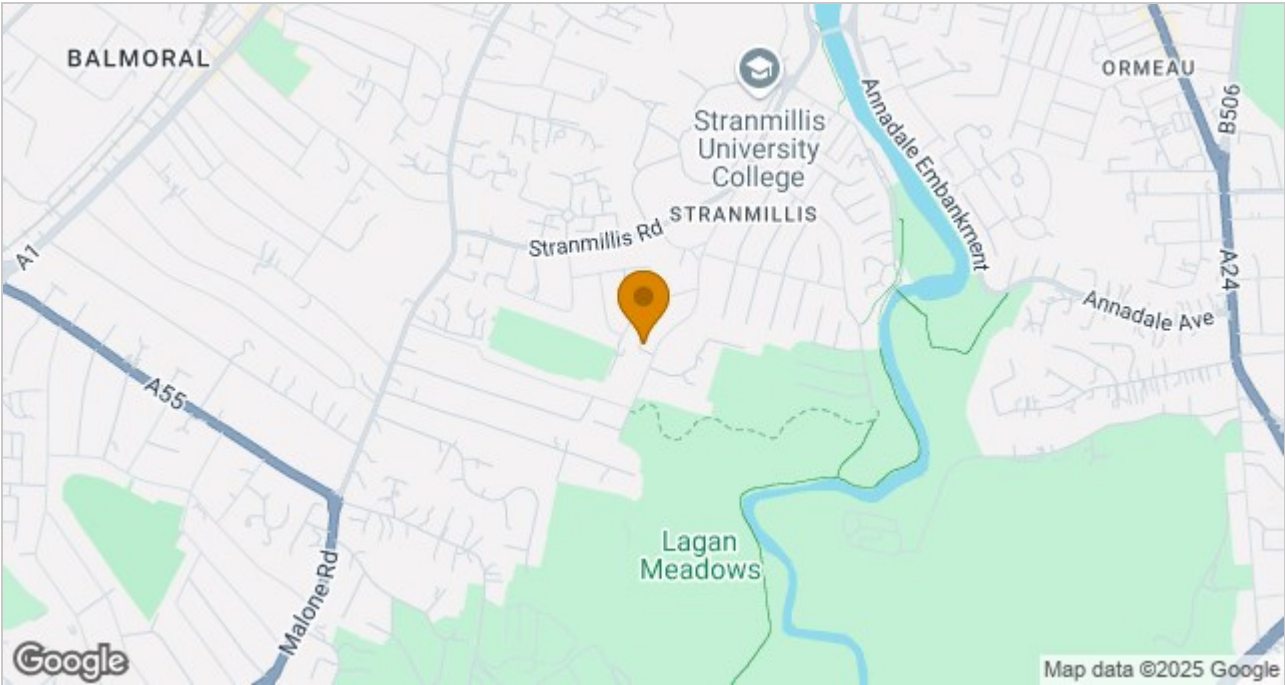

These particulars, whilst believed to be accurate are set out as a general outline only for guidance and do not constitute any part of an offer or contract. Intending purchasers should not rely on them as statements of representation of fact, but must satisfy themselves by inspection or otherwise as to their accuracy. No person in this firms employment has the authority to make or give any representation or warranty in respect of the property.

ULSTERPROPERTYSALES.CO.UK

ANDERSONSTOWN 028 9060 5200	BANGOR 028 9127 1185	DONAGHADEE 028 9188 8000	GLENGORMLEY 028 9083 3295	RENTAL DIVISION 028 9070 1000
BALLYHACKAMORE 028 9047 1515	CARRICKFERGUS 028 9336 5986	DOWNPATRICK 028 4461 4101	MALONE 028 9066 1929	
BALLYNAHINCH 028 9756 1155	CAVEHILL 028 9072 9270	FORESTSIDE 028 9064 1264	NEWTOWNARDS 028 9181 1444	



John Thompson trading under licence as Ulster Property Sales (Downpatrick)  
©Ulster Property Sales is a Registered Trademark