



MARC FEGAN
BESPOKE ESTATE AGENT

6 Willowfield Crescent , Craigavon, BT65 5HQ

Offers over £144,950



Beautiful three bedroom semi detached home located in the well regarded Willowfield Crescent development in Craigavon. The property is modern and well presented throughout and given its size and location would make an ideal purchase for first time buyers and families alike. As well as boasting three double bedrooms the property also offers a spacious family bathroom, downstairs WC, lounge with feature open fire and open plan kitchen/diner with double doors opening onto a spacious rear garden.

The location is excellent and is within walking distance to local primary and secondary schools, local amenities and public transport links. Lurgan, Portadown and Rushmere are within easy reach and for commuters the M1 motorway is a 5 minute drive.

Viewings are strictly by appointment only.

Agent's View



MARC FEGAN



MARC FEGAN



MARC FEGAN

Area Map



Floor Plans

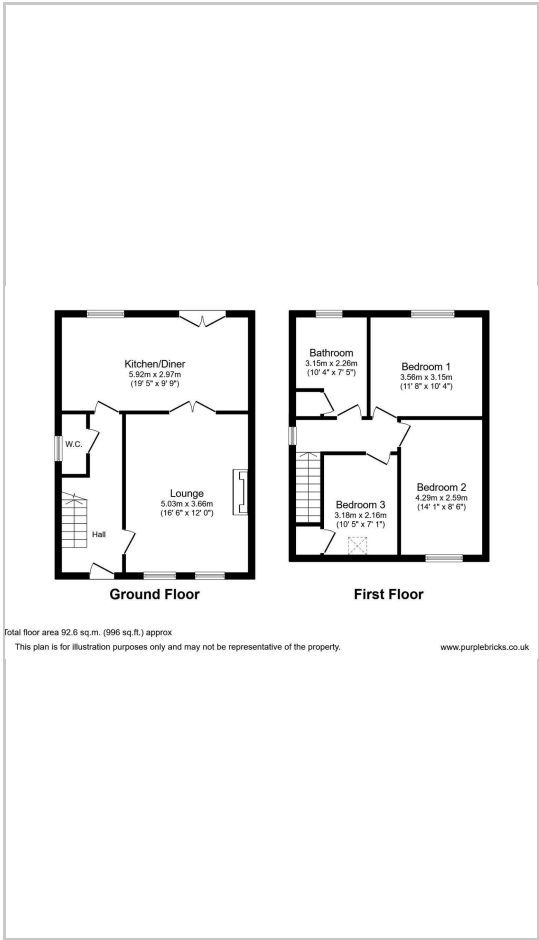

Energy Efficiency Graph

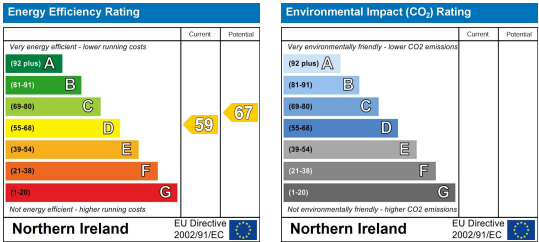

These particulars, whilst believed to be accurate are set out as a general outline only for guidance and do not constitute any part of an offer or contract. Intending purchasers should not rely on them as statements of representation of fact, but must satisfy themselves by inspection or otherwise as to their accuracy. No person in this firms employment has the authority to make or give any representation or warranty in respect of the property.