

Station Court, Stoneyford Road,
Lisburn, County Antrim, BT28

Asking Price: £144,950 To be advised

 **Reeds Rains**

reedsrains.co.uk

Station Court, Stoneyford Road, Lisburn, County Antrim, BT28

Asking Price: £144,950 To be advised

Council Tax Band:

EPC Rating: TBC

Charming end of terrace house boasting 3 bedrooms, a spacious living area, and a well-maintained garden. Situated in a sought-after location close to local amenities and excellent transport links. Don't miss out on this fantastic opportunity to own a wonderful family home.

Road, Belfast, Co Antrim, N Ireland BT7 2FZ, 10 High Street, Carrickfergus, Co Antrim, N Ireland BT38 7AF, 8/8A Carnmoney Road, Glengormley, County Antrim, N Ireland BT36 6HN, 14/16 Market Street, Lisburn, County Antrim, N Ireland BT28 1AB and 2 Frances Street, Newtownards, County Down, N Ireland BT23 4JA are operated by Favscio NI Limited which is independently owned and operated under a Licence from Reeds Rains Limited.

Entrance Hall

All Measurements
All Measurements are Approximate.

Living Room

14'6" x 10'9" (4.42m x 3.28m)

Open to kitchen/ casual dining area.

Laser Tape Clause
All measurements have been taken using a laser tape measure and therefore, may be subject to a small margin of error.

Floorplan Clause
Measurements are approximate. Not to Scale. For illustrative purposes only.

Kitchen

10'9" x 6'8" (3.28m x 2.03m)

Excellent fitted range of high and low level units, built-in appliances, plumbed for washing machine, sink unit.

WC/ Cloaks

Low level WC, wash hand basin.

Landing

Bedroom 2

11'6" x 11'3" (3.5m x 3.43m)

Built-in robes.

Bedroom 3

7'9" x 6'5" (2.36m x 1.96m)

Built-in robes.

Family Bathroom Suite

Comprising panelled bath, separate shower cubicle, low level WC, wash handbasin, wall tiling.

Bedroom 1

14'6" x 8'4" (4.42m x 2.54m)

Built-in robes/ Eaves.

Front Car Parking.

The Reeds Rains branches at 350 Upper Newtownards Road, Ballyhackamore, Belfast, N Ireland BT4 3EX, 18 Main Street, Bangor, Co Down, N Ireland BT20 5AG, Somerset House, 240-242 Ormeau

We may refer you to recommended providers of ancillary services such as Conveyancing, Mortgages, Insurance and Surveying. We may receive a referral fee for recommending their services. You are not under any obligation to use the services of the recommended provider, which may also be an associated company of Reeds Rains.

For full EPC please contact the branch.

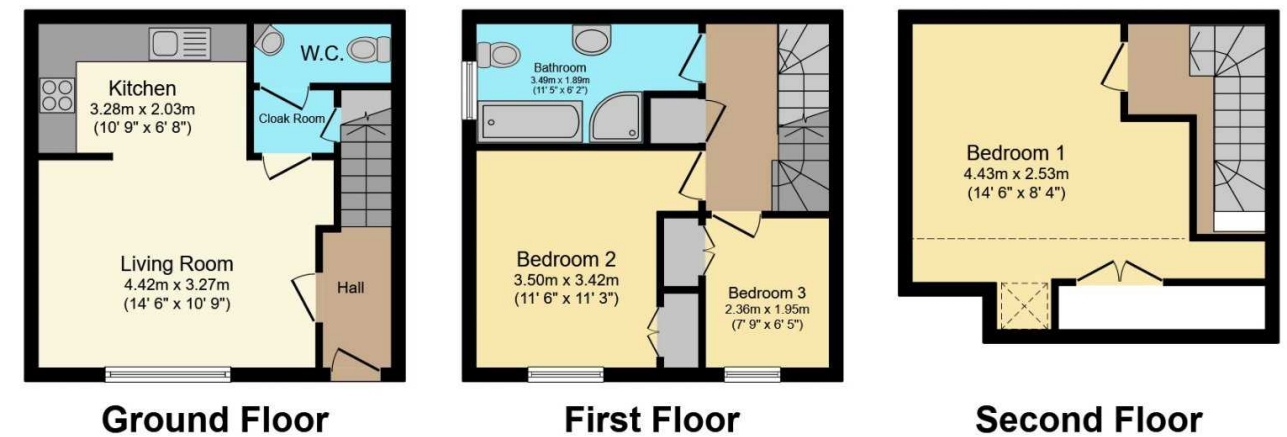

Total floor area 83.5 sq.m. (899 sq.ft.) approx

This floor plan is for illustrative purposes only. It is not drawn to scale. Any measurements, floor areas (including any total floor area), openings and orientation are approximate. No details are guaranteed, they cannot be relied upon for any purpose and they do not form part of any agreement. No liability is taken for any error, omission or misstatement. A party must rely upon its own inspection(s).
Powered by www.focalagent.com

Other important information which you will need to know about this property can be found at reedsrains.co.uk