



100 Donnybrook Street, Belfast, BT9 7DG

Offers Over £145,000

We are pleased to present this excellent mid-terrace property located just off the Lisburn Road, convenient to a host of amenities and will appeal to a range of buyers. Bright and spacious throughout the property comprises on the ground floor, open plan living / dining area, large fitted kitchen with access to enclosed yard to rear. On the first floor there are two good size bedrooms and bathroom suite. Gas fired central heating and PVC double glazing are both in place.

- Excellent Mid-Terrace Property
- Large Fitted Kitchen
- First Floor Bathroom Suite
- PVC Double Glazed Windows
- Open Plan Living / Dining Area
- Two Good Size Bedrooms
- Gas Fired Central Heating
- Popular Location

Energy Efficiency Rating		Current	Potential
(92-100)	A		
(81-91)	B		
(69-80)	C	71	71
(55-68)	D		
(39-54)	E		
(21-38)	F		
(1-20)	G		

Not energy efficient - higher running costs

Northern Ireland

EU Directive 2002/91/EC

THE ACCOMMODATION COMPRISES

ON THE GROUND FLOOR

ENTRANCE

Hardwood front door with glass panels.
Laminate flooring.

OPEN PLAN LIVING / DINING ROOM 20'0" x 9'2" (6.1 x 2.8)



Open fire with brick surround and laminate flooring



KITCHEN 13'1" x 7'6" (4.0 x 2.3)



Range of high and low level units, stainless steel sink unit with drainer, plumbed for washing machine, part tiled walls and vinyl flooring. Under stairs storage.

ON THE FIRST FLOOR

BEDROOM ONE 12'1" x 9'10" (3.7 x 3.0)



Laminate flooring with built in storage.

BEDROOM TWO 10'2" x 7'2" (3.1 x 2.2)



Laminate flooring with built in storage.

BATHROOM



Low flush W.C, wash hand basin with built in vanity unit, panel bath, part tiled walls and vinyl flooring. Built in storage.

OUTSIDE



Small front with enclosed yard to rear.

Floor Plan

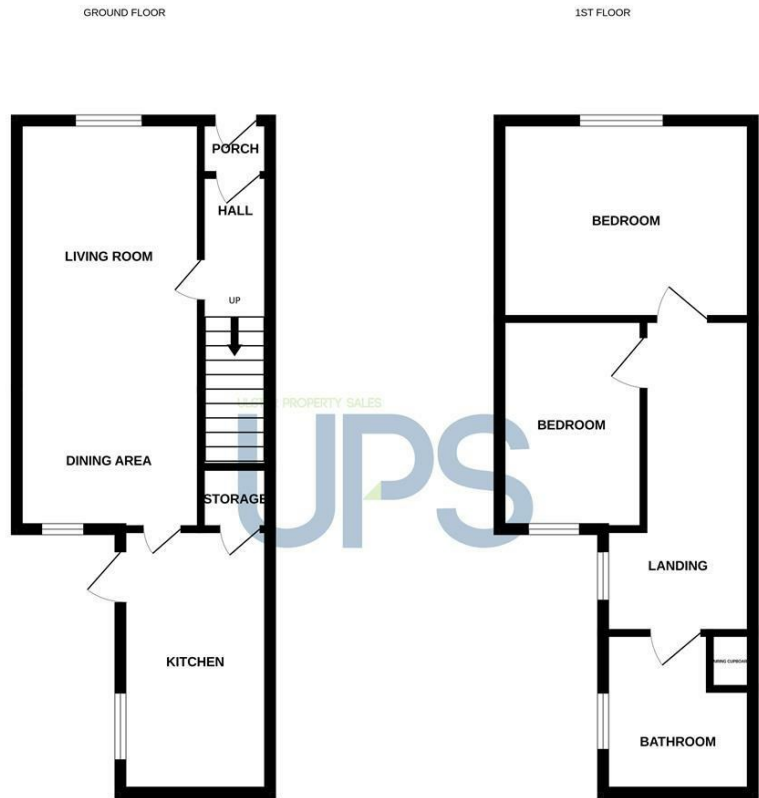

Whilst every attempt has been made to ensure the accuracy of the floorplan contained here, measurements of doors, windows, stairs and any other items are approximate and no responsibility is taken for any omission or mis-statement. This plan is for illustrative purposes only and should be used as such by any prospective purchaser. The services, systems and appliances shown have not been tested and no guarantee as to their operability or efficiency can be given. Made with Metropex C025.

Area Map

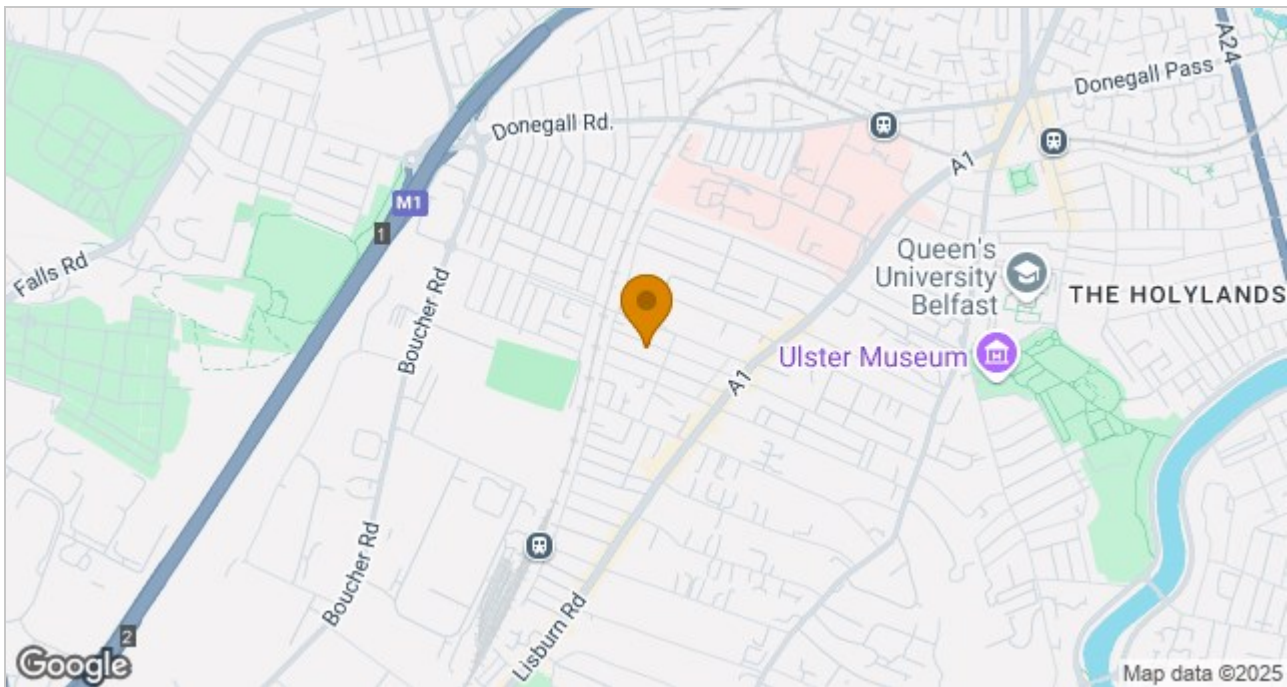

These particulars, whilst believed to be accurate are set out as a general outline only for guidance and do not constitute any part of an offer or contract. Intending purchasers should not rely on them as statements of representation of fact, but must satisfy themselves by inspection or otherwise as to their accuracy. No person in this firm's employment has the authority to make or give any representation or warranty in respect of the property.

ULSTERPROPERTYSALES.CO.UK

ANDERSONSTOWN
028 9060 5200

BALLYHACKAMORE
028 9047 1515

BALLYNAHINCH
028 9756 1155

BANGOR
028 9127 1185

CARRICKFERGUS
028 9336 5986

CAVEHILL
028 9072 9270

DONAGHADEE
028 9188 8000

DOWNPATRICK
028 4461 4101

FORESTSIDE
028 9064 1264

GLENGORMLEY
028 9083 3295

MALONE
028 9066 1929

NEWTOWNARDS
028 9181 1444

RENTAL DIVISION
028 9070 1000



John Thompson trading under licence as Ulster Property Sales (Downpatrick)
©Ulster Property Sales is a Registered Trademark