



1 Stonebridge Drive Conlig, Newtownards, BT23 7QS

Although less than 20 years old this spacious detached property has already seen significant modernisation and boasts a practical side extension which would be ideal for a large or multi-generational family.

Presented to an exacting standard throughout, the property provides generous accommodation of over 1,700 sq.ft. The first floor offers 4 bedrooms, including a master with en-suite shower room, and a luxury family bathroom. The original ground floor includes a spacious lounge, with feature fireplace & patio doors to the rear garden, a modern, open plan kitchen/living/diner & a ground floor cloakroom. The real stand out feature of this property, however, is the excellent ground floor extension which adds a utility area and wheel chair friendly access to a spacious double bedroom and walk in shower room - perfect for a dependent relative perhaps? The property benefits from uPVC double glazing & fascia and oil fired central heating.

Externally there is parking to the front and landscaped gardens to the front, side & south facing rear offering sun light, privacy and low maintenance in equal measure.

Ideally positioned for access to Bangor, Newtownards or beyond this would make an enviable family home and internal viewing is essential to fully appreciate all that is on offer.

Offers Over £299,950

1 Stonebridge Drive

Conlig, Newtownards, BT23 7QS



- Beautifully presented & extended detached home
- Modern kitchen/living/diner + utility area
- Landscaped gardens to front, side & south facing to rear
- Ground floor ideal for dependent relative
- Up to 5 bedrooms - 2 en-suite - One on ground floor
- Luxury family bathroom + ground floor cloakroom
- Summer house/garden room/gym
- Lounge with feature fireplace
- uPVC double glazing & fascia - Oil fired central heating
- Convenient to Newtownards, Bangor & beyond

Entrance

Entrance hall

18'4x6'6 (5.59mx1.98m)

Lounge

21'10x12 (6.65mx3.66m)

Kitchen/living/diner

21'10x12 (6.65mx3.66m)

Utility area

19'4x5'1 (5.89mx1.55m)

Bedroom 5

16x12'11 (4.88mx3.94m)

Ensuite shower room

8x7'2 (2.44mx2.18m)

Ground floor WC

8'1x3 (2.46mx0.91m)

Landing

Bathroom

11x5'9 (3.35mx1.75m)

Bedroom 1

12'4x12 (3.76mx3.66m)

Ensuite shower room

9'4x2'10 (2.84mx0.86m)

Bedroom 2

12'5x12 (3.78mx3.66m)

Bedroom 3

12x9 (3.66mx2.74m)

Bedroom 4

9'1x7'8 (2.77mx2.34m)

Outside

Tenure

Property misdescriptions



Directions

Travelling away from the Ards/Bangor dual carriageway along Green Road turn right into Stonebridge Avenue then left into Stonebridge Drive and number 1 is located on the right.



Floor Plan

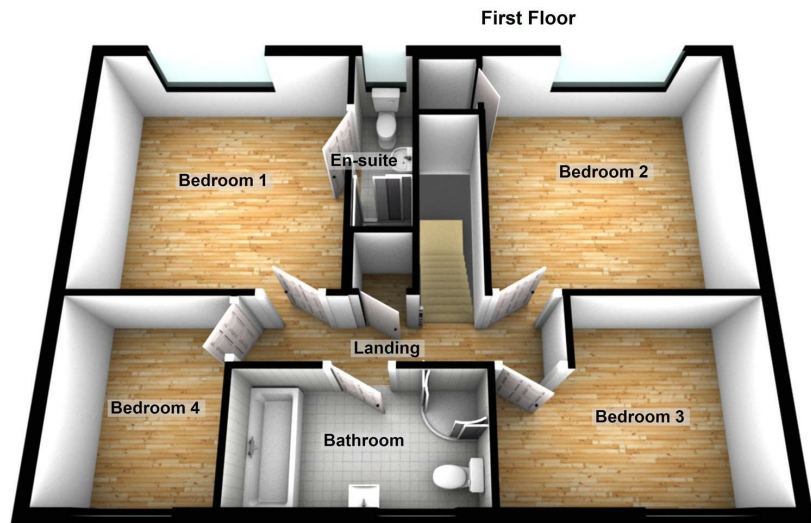
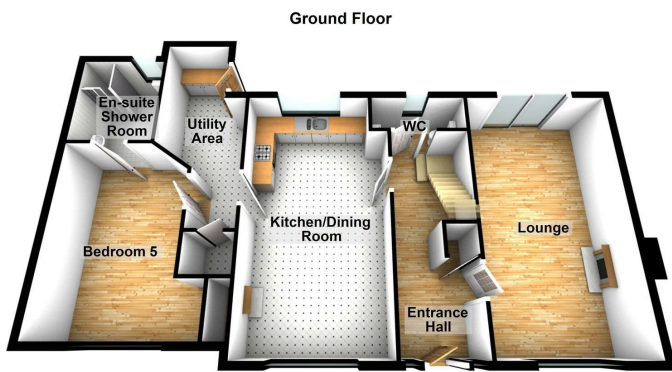

These particulars, whilst believed to be accurate are set out as a general outline only for guidance and do not constitute any part of an offer or contract. Intending purchasers should not rely on them as statements of representation of fact, but must satisfy themselves by inspection or otherwise as to their accuracy. No person in this firm's employment has the authority to make or give any representation or warranty in respect of the property.

