

For Sale
By Private Treaty

Guide Price
€295,000

REA
JOHN LEE



REA
JOHN LEE

BER E1

Abington

MURROE, CO. LIMERICK.

V94 E2WC

5 Bedroom Bungalow Residence on c. 1.03 Acres



reajohnlee.ie

PSRA: 002764



| Location

This property is situated 2.4km from Murroe village, 15 minutes from the University of Limerick, 5 minutes from Annacotty Business Park and only 20 minutes from Limerick City with easy access to the M7 motorway. This is a scenic, countryside setting surrounding by a rolling agricultural hinterland.

| Description

REA John Lee are delighted to bring to the market this spacious 5 bedroom bungalow residence. The property is set on a mature site extending to c. 1.03 acres and requires upgrading and modernisation throughout. Located in a sought after area this presents an ideal environment for families seeking a tranquil lifestyle within easy commuting distance of Limerick City and University. The residence offers a blank canvas for upgrading while the site is perfect for outdoor activities or gardening. Appointment to view can be arranged through the agent agents.

Services include; Mains ESB, Mains Water, Oil Fired Central Heating, Septic tank, double glazed windows.

Built c. 1979. c. 122 sq.m.

Call 061 378 121



Accommodation

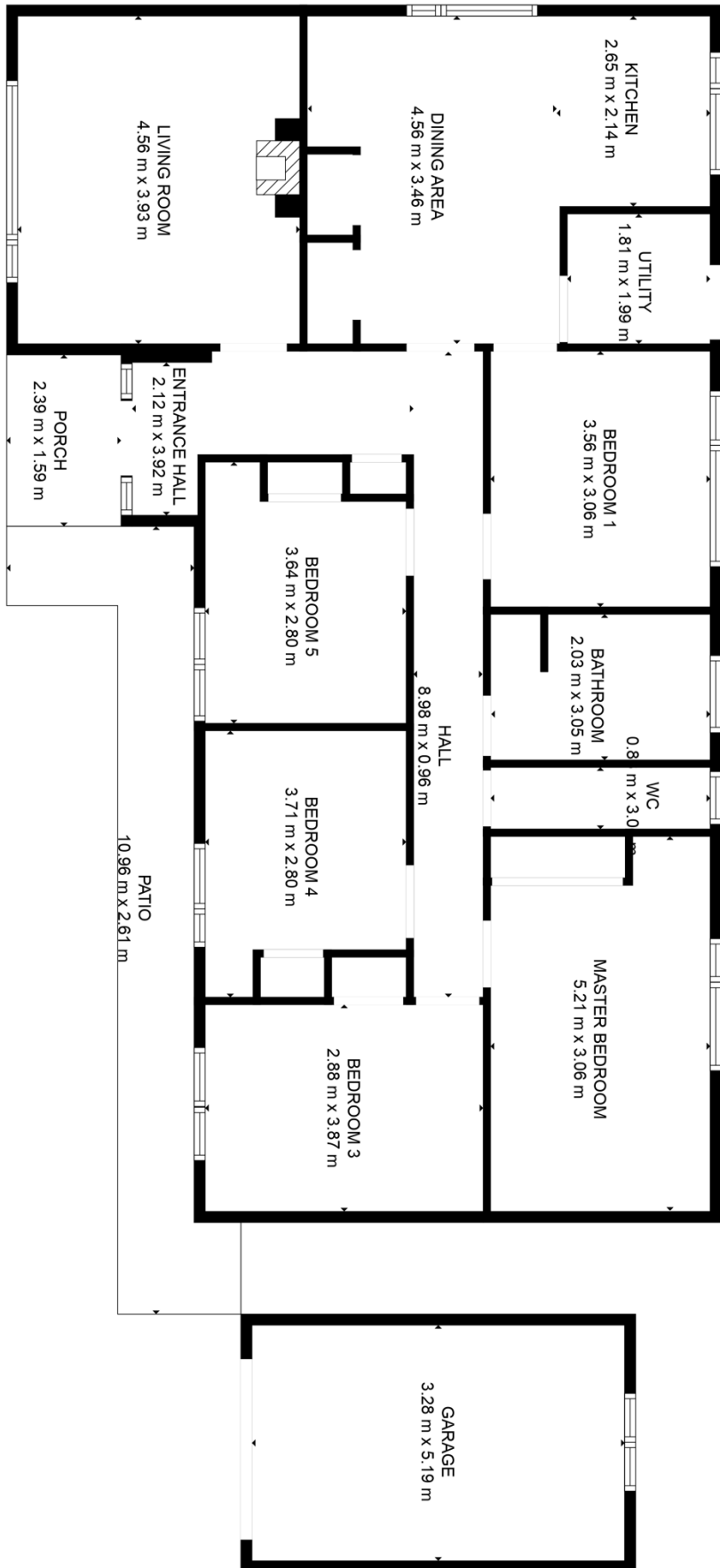

FLOOR PLAN CREATED BY CUBICASA APP. MEASUREMENTS DEEMED HIGHLY RELIABLE BUT NOT GUARANTEED.

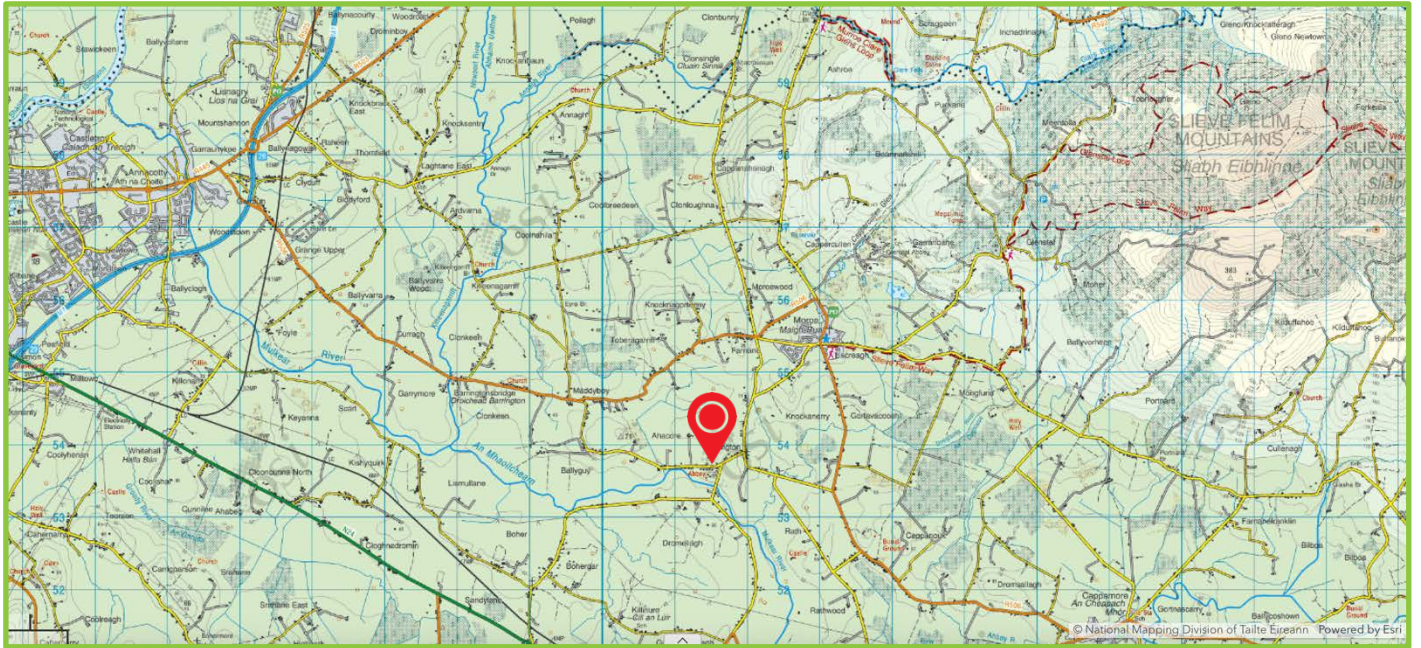

| Outside

The property enjoys an excellent location convenient to Murroe village with easy access to Limerick City. The gardens are mature to the front and rear with ample room for further development. The detached garage to one side is suitable to utilise as a workshop while the rear site has excellent access.

| BER

E1
329.2 kWh/m²/yr
BER No. 118280858

| Viewing

By prior appointment.

| Directions

Coming into Murroe from Limerick the property is on the left adjacent to Powers Pub.
Eircode: V94 E2WC

| Price

€295,000



| Selling agents

REA John Lee
Main Street,
Newport,
Co. Tipperary.
V94 FC8Y

T 061 378121
E info@reajohnlee.ie
W www.reajohnlee.ie

| Sales agent

James Lee
BSc. Hon's., MRICS MSCSI
Director

T (086) 235 1221
E james@reajohnlee.ie

CONDITIONS TO BE NOTED: The terms set out herein are by way of partial summary. Intending purchasers should obtain a copy of the Conditions of Sale where the matters are dealt with comprehensively. Particulars and Conditions of sale are available from the Agents and the Solicitors with carriage of sale. REA John Lee for themselves and for the vendors whose agents they are, give notice that: 1) The particulars are set out in this Brochure and Schedule as a general outline for the guidance of intending purchasers and do not constitute part of an offer or contract. 2) All descriptions, dimensions, references to condition and necessary permissions for the use and occupation and other details are given in good faith and are believed to be correct but any intending purchasers should not rely on them as statements or representations of fact but must satisfy themselves by inspection or otherwise as to the correctness of each of them. 3) No person in the employment of REA John Lee has any authority to make representations or warranty whatsoever in relation to this property. All prices quoted are exclusive of VAT