



36 Empire Drive, Belfast, BT12 6GQ

Price Guide £110,000

Situated in a popular residential street just off the Donegall Road, this mid terrace is bright and spacious throughout and comprises, on the ground floor, open plan kitchen, living, dining area and study. On the first floor there are two good sized bedrooms and white bathroom suite. Further benefits include, Gas fired central heating & PVC double glazed windows. Outside the property benefits from enclosed front garden and enclosed yard to rear. Close to a range of excellent amenities, transport links and the City Centre within walking distance. With similar houses selling fast in the area early viewing is advised.

- Spacious Mid-Terrace Property
- Open Plan Kitchen / Living / Dining Area
- Two Good Sized Bedrooms With Separate Study
- First Floor Bathroom Suite
- Gas Central Heating
- PVC Double Glazed Windows
- Ideal First Time Buy / Investment
- Convenient Location

Energy Efficiency Rating		Current	Potential
(92-100)	A		
(81-91)	B		
(69-80)	C		
(55-68)	D	64	68
(39-54)	E		
(21-38)	F		
(1-20)	G		

Not energy efficient - higher running costs

Northern Ireland EU Directive 2002/91/EC

THE ACCOMMODATION COMPRISES

ON THE GROUND FLOOR

KITCHEN / LIVING / DINING AREA 20'8" x 13'1" (6.3 x 4.0)



Excellent range of high and low level units, stainless steel sink unit with mixer tap, built in oven with 4 ring gas hob, plumbed for washing machine, extractor fan, part tiled walls and laminate flooring.



Laminate flooring



STUDY 6'6" x 6'6" (2.0 x 2.0)



Built in storage.

ON THE FIRST FLOOR

BEDROOM ONE 13'1" x 10'2" (4.0 x 3.1)



BEDROOM TWO 9'10" x 7'6" (3.0 x 2.3)



BATHROOM



White suite comprising low flush W.C, pedestal wash hand basin, panel bath, shower cubicle with thermostatic shower, extractor fan, fully tiled walls and vinyl flooring.

OUTSIDE



Garden to front. Enclosed yard to rear.

Floor Plan

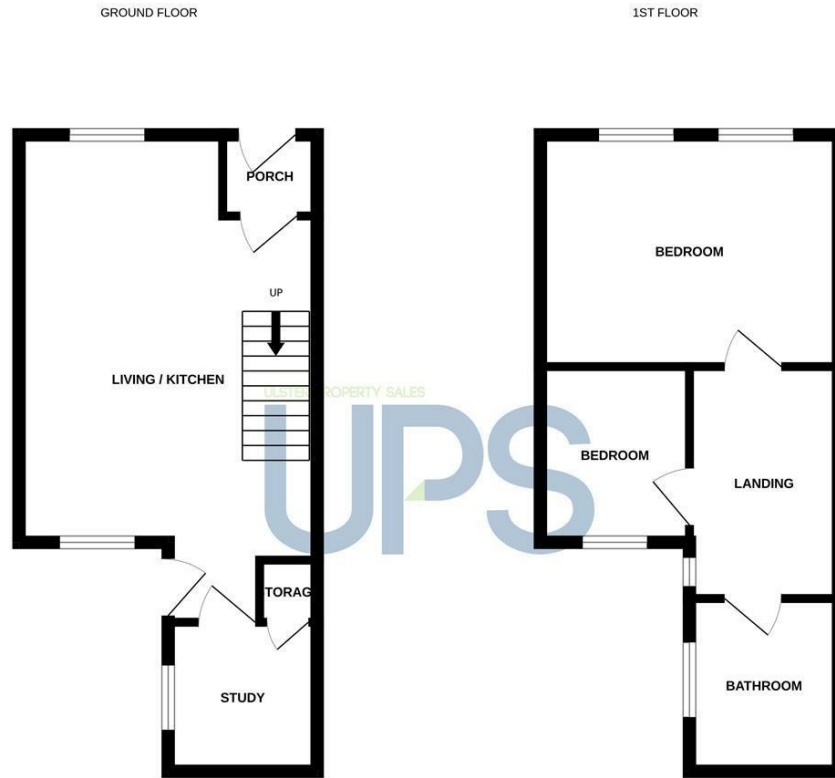

Whilst every attempt has been made to ensure the accuracy of the floorplan contained here, measurements of doors, windows, rooms and any other items are approximate and no responsibility is taken for any error, omission or mis-statement. This plan is for illustrative purposes only and should be used as such by any prospective purchaser. The services, systems and appliances shown have not been tested and no guarantee as to their operability or efficiency can be given. Made with Metropex ©2025

Area Map

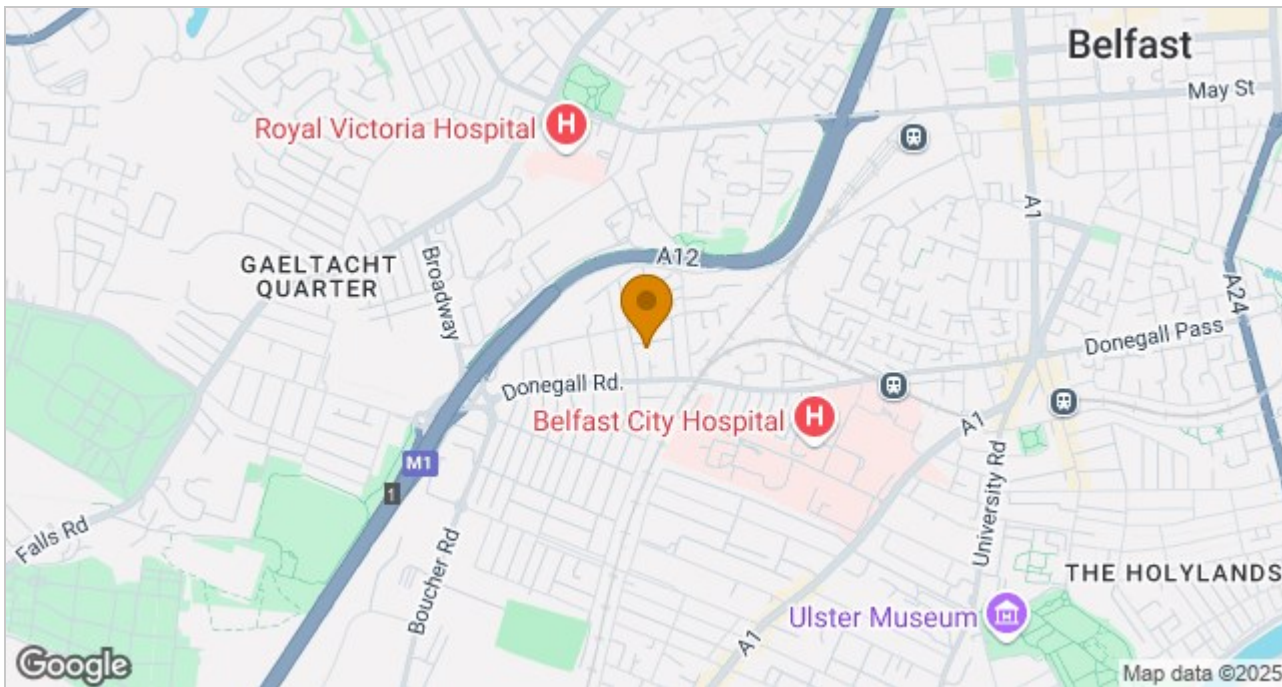

These particulars, whilst believed to be accurate are set out as a general outline only for guidance and do not constitute any part of an offer or contract. Intending purchasers should not rely on them as statements of representation of fact, but must satisfy themselves by inspection or otherwise as to their accuracy. No person in this firm's employment has the authority to make or give any representation or warranty in respect of the property.

ULSTERPROPERTYSALES.CO.UK

ANDERSONSTOWN
028 9060 5200

BANGOR
028 9127 1185

DONAGHADEE
028 9188 8000

GLENGORMLEY
028 9083 3295

RENTAL DIVISION
028 9070 1000

BALLYHACKAMORE
028 9047 1515

CARRICKFERGUS
028 9336 5986

DOWNPATRICK
028 4461 4101

MALONE
028 9066 1929

BALLYNAHINCH
028 9756 1155

CAVEHILL
028 9072 9270

FORESTSIDE
028 9064 1264

NEWTOWNARDS
028 9181 1444



John Thompson trading under licence as Ulster Property Sales (Downpatrick)
©Ulster Property Sales is a Registered Trademark