



The Todd (BH6)

Render finish. Site nos. 6, 7, 16, 17, 103, 104

Note: Site nos. 6, 7, 16, 17 will be a handed version

3 Bedroom | Semi Detached | Total Area: 1156 sq ft

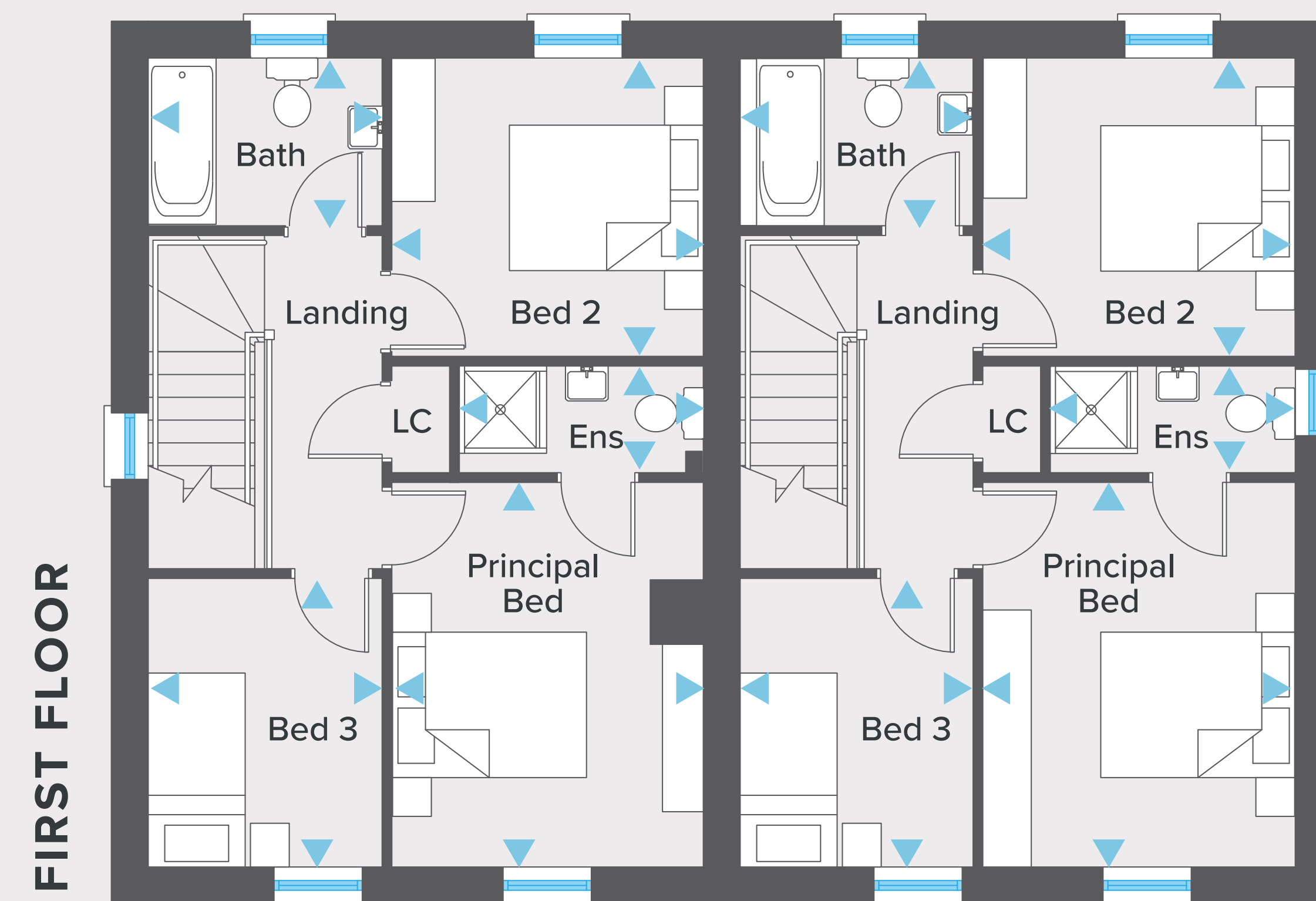

GROUND FLOOR

	Ft/Inch	Metres
Entrance Hall with separate WC		
Drawing Room inc bay	17'7" x 10'7"	5.38 x 3.22
Kitchen Dining	18'10" x 13'4"	5.76 x 4.04
Sun Room	9'7" x 8'9"	2.95 x 2.70

FIRST FLOOR

	Ft/Inch	Metres
Principal Bedroom	13'1" x 10'8"	3.99 x 3.25
Ensuite	8'4" x 3'7"	2.55 x 1.10
Bedroom 2	10'8" x 10'2"	3.25 x 3.10
Bedroom 3	9'10" x 7'10"	3.00 x 2.41
Bathroom	7'10" x 5'9"	2.41 x 1.75

The Todd

Site nos. 6, 7, 16, 17, 103, 104
(BH6) Note: Site nos. 6, 7, 16, 17 will be a handed version of these plans