



## 7 Dromore Court, Upper Dromore Road Warrenpoint, Newry, BT34 3UU

**Offers Over £137,500**

Situated on the Upper Dromore Road, Warrenpoint, this delightful ground floor apartment offers a perfect blend of comfort and convenience. With two well-proportioned bedrooms, this property is ideal for individuals, couples, or small families seeking a welcoming home in a desirable location.

The apartment features a spacious reception room, providing an inviting space for relaxation and entertaining. The double glazing throughout ensures a warm and quiet environment, while the efficient gas heating system adds to the overall comfort of the home, making it a cosy retreat during the colder months.

One of the standout features of this property is that no further outlay is required, allowing you to move in with ease and start enjoying your new home right away. The surrounding area boasts a friendly community atmosphere, with local amenities and scenic views just a stone's throw away.

This apartment presents an excellent opportunity for those looking to invest in a property that combines modern living with a touch of tranquillity. Don't miss the chance to make this charming apartment your new home in Warrenpoint.

# 7 Dromore Court, Upper Dromore Road

Warrenpoint, Newry, BT34 3UU



- Ground floor apartment
- Gas Heating
- Double Glazing
- Within walking distance to local amenities.

## Entrance Hall

## Living Room

11'5" x 9'8" (3.49 x 2.97)

## Kitchen

11'8" x 11'5" (3.58 x 3.49)

## Bedroom 1

12'11" x 9'8" (3.94 x 2.97)

## Bedroom 2

14'4" 9'5" (4.39 2.88)

## Bathroom

14'4" x 6'5" (4.39 x 1.97)

## External



Energy Efficiency Rating		
	Current	Potential
Very energy efficient - lower running costs		
(92 plus) A		
(81-91) B		
(69-80) C	78	79
(55-68) D		
(39-54) E		
(21-38) F		
(1-20) G		
Not energy efficient - higher running costs		
Northern Ireland		EU Directive 2002/91/EC





## Floor Plan

GROUND FLOOR  
714 sq.ft. (66.4 sq.m.) approx.

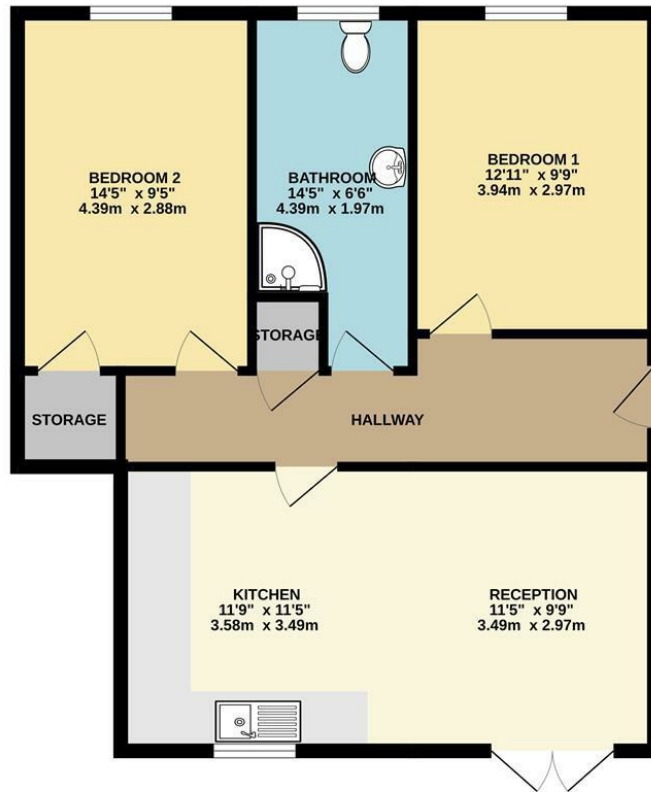

TOTAL FLOOR AREA : 714 sq.ft. (66.4 sq.m.) approx.  
Whilst every attempt has been made to ensure the accuracy of the floorplan contained here, measurements of doors, windows, rooms and any other items are approximate and no responsibility is taken for any error, omission or mis-statement. This plan is for illustrative purposes only and should be used as such by any prospective purchaser. The services, systems and appliances shown have not been tested and no guarantee is given as to their operability or efficiency can be given.  
Made with Metropix 12/2025

*We look forward to working with you...*



*We get there together*

Our experienced and trusted team have assisted 1000's of people with buying, selling and letting.



*We're here for you*

Client care is at the very heart of what we do. We will guide and support you every step of the way.



*Always close by*

With multiple offices and a leading marketing team, we will make sure that you get the very best result.

**Newry:**  
30 Monaghan Street, Newry, Co.Down, BT35 6AA  
T: 028 300 50633 E: newry@bradleyni.com

**Warrenpoint:**  
25 Duke Street, Warrenpoint, Co.Down, BT34 3JY  
T: 028 417 73777 E: warrenpoint@bradleyni.com

**Rostrevor:**  
14 Bridge Street, Rostrevor, Co.Down, BT34 3BG  
T: 028 417 39999 E: rostrevor@bradleyni.com

**Belfast:**  
55-59 Adelaide Street, Belfast, Co.Antrim, BT2 8FE  
T: 028 962 09909 E: belfast@bradleyni.com

These particulars, whilst believed to be accurate are set out as a general outline only for guidance and do not constitute any part of an offer or contract. Intending purchasers should not rely on them as statements of representation of fact, but must satisfy themselves by inspection or otherwise as to their accuracy. No person in this firms employment has the authority to make or give any representation or warranty in respect of the property.