



Bond
Oxborough
Phillips

Changing Lifestyles

60 Beechwood Drive
Camelford
PL32 9NB



BRITISH
PROPERTY
AWARDS

2025



GOLD WINNER

ESTATE AGENT IN
WADEBRIDGE & ROCK



Guide Price - £280,000



Changing Lifestyles

01208 814055

60 Beechwood Drive, Camelford

Charming Three-Bedroom Home in Desirable Camelford Location.



- CHAIN FREE
- EPC - D
- Council Banding- C
- Three well-proportioned bedrooms
- Bright open-plan living and dining room with French doors to the garden
- Modern, well-equipped kitchen
- Ground-floor WC for added convenience
- Contemporary family bathroom
- Private parking and garage
- Enclosed, low-maintenance garden
- Sought-after residential location in Camelford



Nestled within the sought-after Beechwood Drive development in Camelford, 60 Beechwood Drive is a stylish and well-maintained three-bedroom end-terraced home. Offering a blend of modern living, practical features, and a convenient location, this property is perfectly suited to first-time buyers, families, or those looking to enjoy life in this charming Cornish town.

Step inside to find a welcoming entrance hall leading into the spacious open-plan living/dining area, ideal for both relaxing and entertaining. The double doors opening onto the garden allow plenty of natural light to flow through and provide a seamless indoor-outdoor connection.

Upstairs, the three bedrooms are served by a sleek and modern family bathroom, all presented to a high standard. Ample storage adds to the home's practicality.

Outside, the property offers private parking, a garage, and a neat, enclosed garden – delivering convenience alongside kerb appeal.

With its excellent location, modern finish, and versatile accommodation, 60 Beechwood Drive represents an exciting opportunity to secure a home in the heart of Camelford.

Changing Lifestyles

Camelford is a charming and historic market town nestled in the picturesque countryside of North Cornwall. Steeped in legend and surrounded by rolling hills, rugged moorland, and scenic riverbanks, it offers a perfect blend of natural beauty and rich heritage. Often associated with the tales of King Arthur due to its proximity to Tintagel, Camelford boasts a welcoming community, quaint streets lined with independent shops, traditional pubs and nearby award winning farm shop cafes. The town is ideally situated for exploring both the stunning North Cornish coastline and the breathtaking landscapes of Bodmin Moor, making it a sought-after location for nature lovers, outdoor enthusiasts, and history buffs alike. With excellent local amenities, good transport links, and a peaceful yet vibrant atmosphere, Camelford provides an idyllic setting for those seeking a balance between rural charm and modern convenience.



Please do not hesitate to contact the team at Bond Oxborough Phillips Sales & Lettings on **01208 814055** for more information or to arrange an accompanied viewing on this property.

Scan here for our Virtual Tour:





Floor 0 Building 1

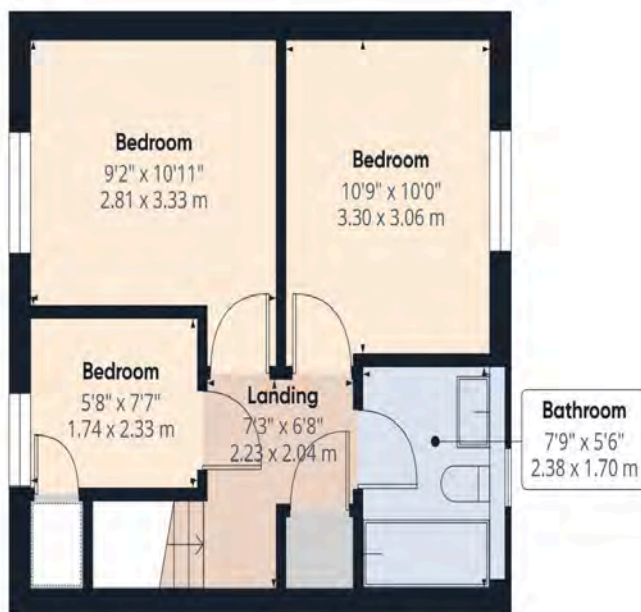

Floor 1 Building 1

Have a property to sell or let?

If you are considering selling or letting your home, get in contact with us today on 01208 814055 to speak with one of our expert team who will be able to provide you with a free valuation of your home.

We have the facility to refer purchasers and vendors to conveyancing, mortgage advisors and Surveyors. It is your decision if you choose to deal with any of these companies however should you choose to use them we would receive a referral fee from them for recommending you. We will receive a referral fee between £50 - £300 depending on the company & individual circumstances. We have carefully selected these associates for the quality of their work and customer service levels.

Consumer Protection Regulations: We have not tested any apparatus, equipment, fixtures and fittings or services and so cannot verify that they are in working order or fit for the purpose. References to the Tenure of a Property are based on information supplied by the seller. We have not had sight of the Title Documents. A buyer is advised to obtain verification from their solicitor or surveyor. Floorplans shown are for guidance only and should not be relied upon. Items shown in photographs are NOT included unless specifically mentioned within these details. They may however be able by separate negotiation. You are advised to check the availability of this property before travelling any distance to view. Particulars are produced in good faith to the best of our knowledge and are set out as a general guide only.