

CRAWFORDSBURN VILLAGE BROW

Crawfordsburn



SITES 17-20

Computer visual.

SITES 17-20

GROUND FLOOR

Entrance Hall with separate WC

Lounge 17'9" x 14'7" max

Kitchen / Dining 17'1" x 13'5" max

Family 10'6" x 10'4"

Utility 8'2" x 5'1" max

FIRST FLOOR

Master Bedroom 12'6" x 10'4" min

Ensuite 6'7" x 6'3" max

Bedroom 2 11'10" x 11'10" min

Bedroom 3 12'10" x 11'10" max

Bedroom 4 10'4" x 9'10" max

Bathroom 8'0" x 6'3"



**TOTAL FLOOR AREA:
1528 SQ. FT. APPROX.**

**Note the gable windows in the Lounge and Kitchen / Dining are only available on Site 20.*

KEY - SITES 17-20

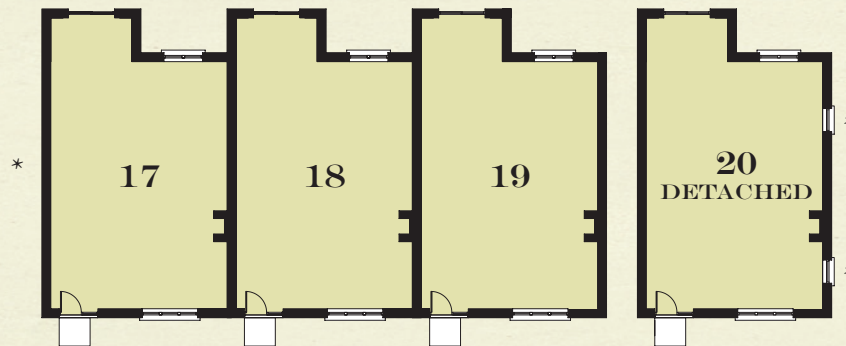

**CRAWFORDSBURN
VILLAGE BROW**

**TEMPLETON
ROBINSON**

NORTH DOWN

54 High Street
Holywood
Co Down
BT18 9AE

028 9042 4747

WWW.TEMPLETONROBINSON.COM

CGI computer visual is for illustrative purposes only. Floorplans are not to scale and all measurements are approximate.